

Part number

TM 16114 IS



Interlocked switched socket-outlet, TM series, 3 poles + PE, 11 h (red), 16 A, 440 ÷ 460 V, sectionable fuse carrier 10 x 38 mm, with base box

Product description

Product type	Interlocked switched socket-outlet
Series	TM.. IS/KIS
N. of poles	3 poles + 
Clock position	11
Specification	Sectionable fuse carrier 10 x 38 mm With base box

Technical data

Current	16 A
Voltage	440 ÷ 460 V
IP degree of protection	IP66 / IP67

Further technical details

Operating temperature range (min, max)	-25°C ... +40°C
UL 94 flammability rating	V-2
IK rating (impact degree of protection)	IK10

Material properties

Colour	RAL 7012 grey, RAL 3000 red
---------------	-----------------------------

Approvals / Standards

Reference standard	EN 60309-1, -2 e -4
---------------------------	---------------------

General ordering information

EAN13 code	8015747160605
-------------------	---------------

Part number

TM 16114 IS



Catalogue drawings

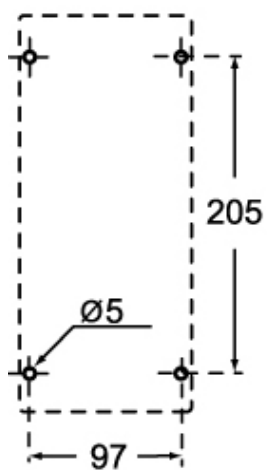

	A	B
2P+⊕	133	276
3P+⊕	135	276
3P+N+⊕	140	277