

Part number

# TM 1414 DB



Box, TM series, with fixed cover, for TM 1456 TB plate

Product description		Material properties	
<b>Product type</b>	Box	<b>Colour</b>	RAL 7012 grey
<b>Series</b>	TM		Compliant with exemption
<b>Specification</b>	With fixed cover For TM 1456 TB plate	<b>RoHs conformity</b>	6(c): copper alloy containing up to 4% lead by weight
Technical data		<b>China RoHs - EFUP</b>	50
<b>IP degree of protection</b>	IP66 / IP67	<b>REACH SVHC substances</b>	Yes Lead
Further technical details		<b>SCIP number</b>	B0214dad-d2d9-4e91-a5b4-f4c9b4612083
<b>Weight</b>	469,00 g	General ordering information	
<b>Operating temperature range (min, max)</b>	-25°C ... +40°C	<b>EAN13 code</b>	8015747089388
<b>IK rating (impact degree of protection)</b>	IK10	Packaging Information	
		<b>Packaging length</b>	500,00 mm
		<b>Packaging height</b>	325,00 mm
		<b>Packaging width</b>	310,00 mm
		<b>Packaging weight</b>	10,10 kg
		<b>Packaging volume</b>	50,38 dm <sup>3</sup>
		<b>Packaging description</b>	Carton box
		<b>Packaging quantity</b>	20 Pcs
		<b>Packaging EAN code</b>	8015747089395
		<b>Sub-packaging weight</b>	0,51 kg
		<b>Sub-packaging description</b>	Plastic packaging
		<b>Sub-packaging quantity</b>	1 Pcs
		<b>Sub-packaging EAN barcode</b>	8015747089401

Part number

**TM 1414 DB**



Catalogue drawings

TM 1114 DB

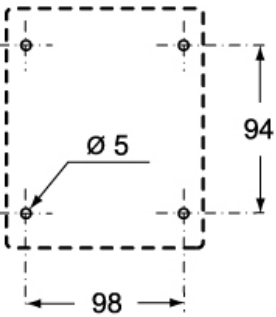
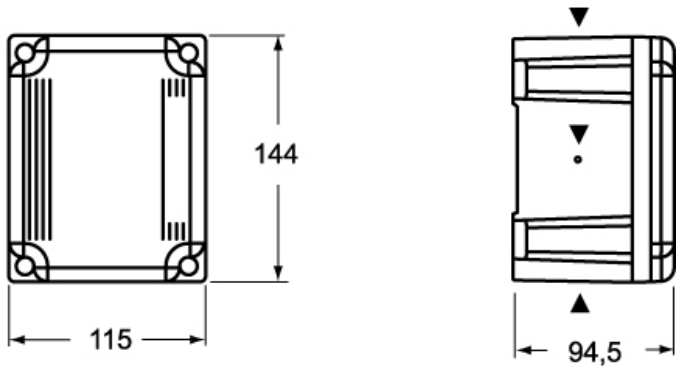

TM 1414 DB

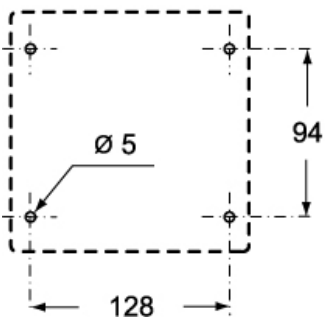
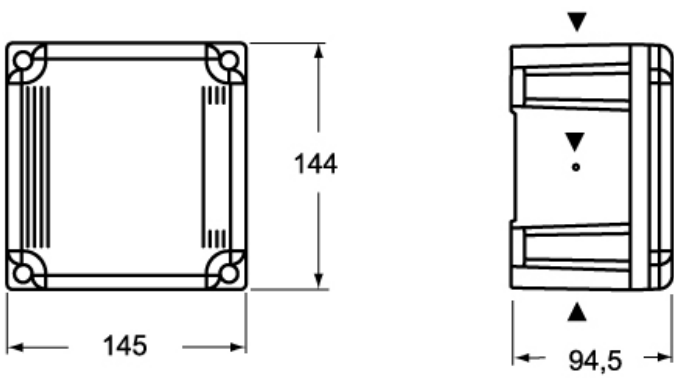

---