

Part number

# SQE 1635.5



Interlocked switched socket-outlet, SQE series, 3 poles + N + PE, 3 h (red), 16 A, 220/380 V, without fuse-carrier

| Product description                            |   |
|--|---|
| <b>Product type</b>                            | Interlocked switched socket-outlet  |
| <b>Series</b>                                  | SQE   |
| <b>N. of poles</b>                             | 3 poles + N +  |
| <b>Clock position</b>                          | 3   |
| <b>Specification</b>                           | Without fuse-carrier  |
| Technical data                                 |   |
| <b>Current</b>                                 | 16 A  |
| <b>Voltage</b>                                 | 220/380V (50Hz) 250/440V (60Hz)   |
| <b>IP degree of protection</b>                 | IP55  |
| Further technical details                      |   |
| <b>Operating temperature range (min, max)</b>  | -25°C ... +40°C   |
| <b>IK rating (impact degree of protection)</b> | IK08  |

| Material properties          |                             |
|------------------------------|-----------------------------|
| <b>Colour</b>                | RAL 7035 grey, RAL 3000 red |
| Approvals / Standards        |                             |
| <b>Reference standard</b>    | EN 60309-1, -2 e -4         |
| General ordering information |                             |
| <b>EAN13 code</b>            | 8015747159876               |

Part number

# SQE 1635.5



Catalogue drawings

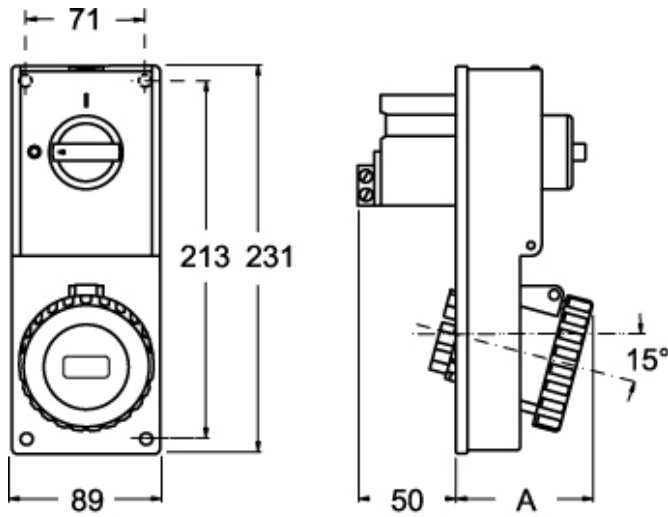

Catalogue drawings

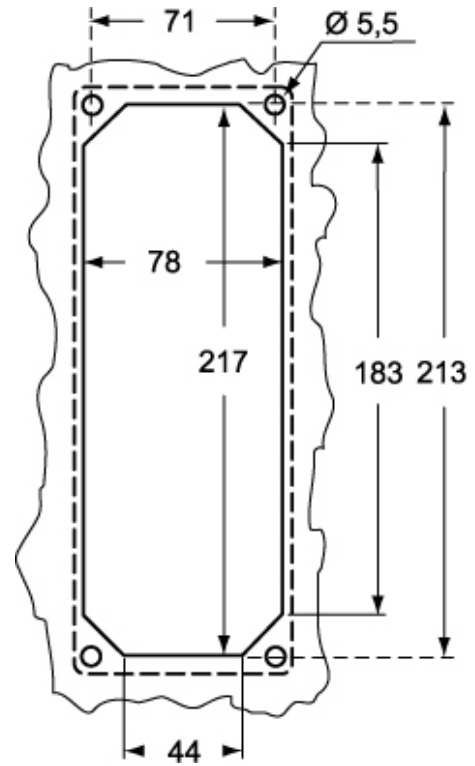

| SQE.5 |        | A  |
|-------|--------|----|
| 16A   | 2P+⊕   | 67 |
|       | 3P+⊕   | 67 |
|       | 3P+N+⊕ | 70 |