

Part number

# PEW 3264 SM



Wall-mounting plug, PLUSO series, 3 poles + PE, 6 h (red), 32 A, 380 ÷ 415 V

| Product description                           |   | Material properties          |   |
|---|---|------------------------------|---|
| <b>Product type</b>                           | Plug<br>Wall-mounting   | <b>Colour</b>                | RAL 7035 grey, RAL 3000 red   |
| <b>Series</b>                                 | PEW...SM, PLUSO   | <b>RoHs conformity</b>       | Compliant with exemption<br>6(c): copper alloy containing up to 4% lead by weight |
| <b>N. of poles</b>                            | 3 poles +  | <b>China RoHs - EFUP</b>     | 50  |
| <b>Clock position</b>                         | 6   | <b>REACH SVHC substances</b> | Yes<br>Lead   |
| Technical data                                |   | <b>SCIP number</b>           | Ca7de37f-add8-4b77-9861-279c94903ade  |
| <b>Current</b>                                | 32 A  | Approvals / Standards        |   |
| <b>Voltage</b>                                | 380 ÷ 415 V   | <b>Reference standard</b>    | EN 60309-1 and -2   |
| <b>IP degree of protection</b>                | IP67  | General ordering information |   |
| Further technical details                     |   | <b>EAN13 code</b>            | 8015747075503   |
| <b>Weight</b>                                 | 472,00 g  | Packaging Information        |   |
| <b>Operating temperature range (min, max)</b> | -25°C ... +40°C   | <b>Packaging weight</b>      | 5,30 kg   |
|   |   | <b>Packaging volume</b>      | 36,36 dm <sup>3</sup>   |
|   |   | <b>Packaging description</b> | Carton box  |
|   |   | <b>Packaging quantity</b>    | 10 Pcs  |
|   |   | <b>Packaging EAN code</b>    | 8015747075510   |

Part number

# PEW 3264 SM



Catalogue drawings

(16 / 32A) PEW ... SM

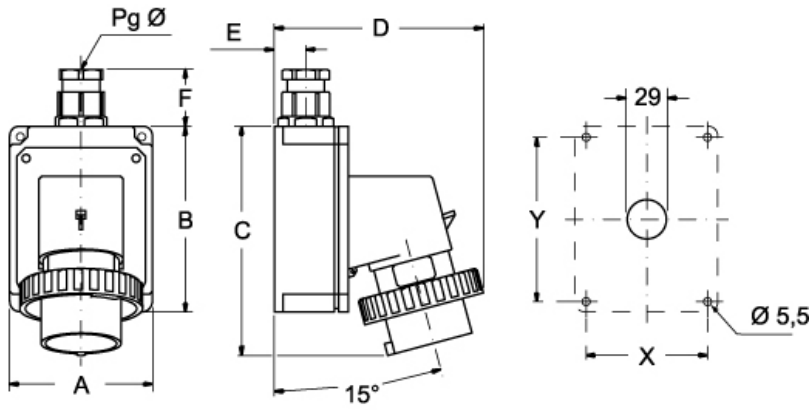

| PEW ... SM |        | A   | B   | C   | D   | E  | F  | X  | Y   | Pg Ø |
|------------|--------|-----|-----|-----|-----|----|----|----|-----|------|
| <b>16A</b> | 2P+⊕   | 75  | 115 | 144 | 126 | 19 | 35 | 65 | 105 | 16   |
|            | 3P+⊕   | 75  | 115 | 144 | 134 | 19 | 35 | 65 | 105 | 16   |
|            | 3P+N+⊕ | 100 | 130 | 164 | 145 | 22 | 42 | 85 | 115 | 21   |
| <b>32A</b> | 2P+⊕   | 100 | 130 | 178 | 154 | 22 | 42 | 85 | 115 | 21   |
|            | 3P+⊕   | 100 | 130 | 178 | 154 | 22 | 42 | 85 | 115 | 21   |
|            | 3P+N+⊕ | 100 | 130 | 178 | 160 | 22 | 42 | 85 | 115 | 21   |