

Part number

PEW 3223 SI



Flush-mounting plug, PLUSO series, 2 poles + PE, 2 h (green), 32 A, > 50 V

Product description

| | |
|-----------------------|---|
| Product type | Plug Flush-mounting |
| Series | PEW...SI, PLUSO |
| N. of poles | 2 poles +  |
| Clock position | 2 |

Technical data

| | |
|--------------------------------|--------|
| Current | 32 A |
| Voltage | > 50 V |
| IP degree of protection | IP67 |

Further technical details

| | |
|---|-----------------|
| Weight | 1,00 g |
| Operating temperature range (min, max) | -25°C ... +40°C |

Material properties

| | |
|------------------------------|--|
| Colour | RAL 7035 grey, RAL 6017 green |
| RoHs conformity | Compliant with exemption 6(c): copper alloy containing up to 4% lead by weight |
| China RoHs - EFUP | 50 |
| REACH SVHC substances | Yes Lead |
| SCIP number | Ca7de37f-add8-4b77-9861-279c94903ade |

Approvals / Standards

| | |
|---------------------------|-------------------|
| Reference standard | EN 60309-1 and -2 |
|---------------------------|-------------------|

General ordering information

| | |
|-------------------|---------------|
| EAN13 code | 8015747157612 |
|-------------------|---------------|

Packaging Information

| | |
|------------------------------|-----------------------|
| Packaging length | 330,00 mm |
| Packaging height | 170,00 mm |
| Packaging width | 352,00 mm |
| Packaging volume | 19,75 dm ³ |
| Packaging description | Carton box |
| Packaging quantity | 10 Pcs |
| Packaging EAN code | 8015747104838 |

Part number

PEW 3223 SI



Catalogue drawings

(16 / 32A) PEW ... SI

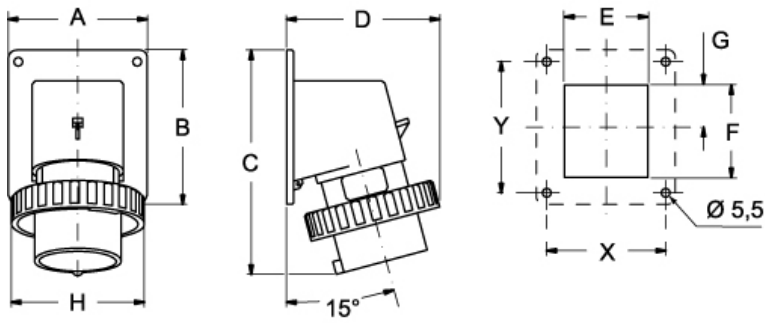

| PEW ... SI | A | B | C | D | E | F | G | H | X | Y |
|-----------------|----|-----|-----|-----|----|----|------|-----|----|----|
| 16A 2P+⊕ | 65 | 82 | 126 | 81 | 41 | 43 | 21,5 | 70 | 52 | 60 |
| 3P+⊕ | 65 | 82 | 126 | 81 | 47 | 43 | 24,5 | 78 | 52 | 60 |
| 3P+N+⊕ | 90 | 100 | 146 | 93 | 54 | 60 | 27,5 | 86 | 77 | 85 |
| 32A 2P+⊕ | 90 | 100 | 160 | 101 | 55 | 60 | 27,5 | 92 | 77 | 85 |
| 3P+⊕ | 90 | 100 | 160 | 101 | 55 | 60 | 27,5 | 92 | 77 | 85 |
| 3P+N+⊕ | 90 | 100 | 160 | 101 | 62 | 60 | 27,5 | 100 | 77 | 85 |