

Part number

# PEW 1654 PQF



Flush-mounting socket outlet, PLUSO series, 3 poles + PE, 5 h (black), 16 A, 600 ÷ 690 V, straight, with bigger flange

## Product description

<b>Product type</b>	Socket Flush-mounting
<b>Series</b>	PEW...PQF, PLUSO
<b>N. of poles</b>	3 poles + 
<b>Clock position</b>	5
<b>Specification</b>	Straight, bigger flange

## Technical data

<b>Current</b>	16 A
<b>Voltage</b>	600 ÷ 690 V
<b>IP degree of protection</b>	IP67

## Further technical details

<b>Operating temperature range (min, max)</b>	-25°C ... +40°C
---	-----------------

## Material properties

<b>Colour</b>	RAL 7035 grey, RAL 9005 black
---------------	-------------------------------

## Approvals / Standards

<b>Reference standard</b>	EN 60309-1 and -2
---------------------------	-------------------

## General ordering information

<b>EAN13 code</b>	8015747157117
-------------------	---------------

Part number

# PEW 1654 PQF



Catalogue drawings

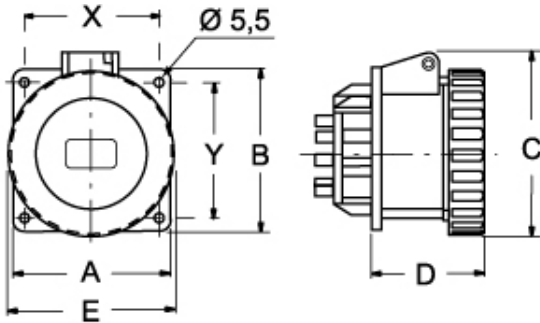

		A	B	C	D	E	X	Y
<b>PQF 16 A</b>	2P+⊖	80	80	--	52	70	60	60
	3P+⊖	80	80	--	52	78	60	60
<b>PQ 16 A</b>	2P+⊖	65	65	77	52	70	52	52
	3P+⊖	65	65	85	52	78	52	52
	3P+N+⊖	80	80	93	52	86	60	60
<b>PQ 32 A</b>	2P+⊖	80	80	98	62	92	60	60
	3P+⊖	80	80	98	62	92	60	60
	3P+N+⊖	80	80	105	62	100	60	60