

Part number

# PEW 1645 PQ



Flush-mounting socket outlet, PLUSO series, 3 poles + N + PE, 4 h (yellow), 16 A, 57/100 ÷ 75/130 V, straight

## Product description

|                       |   |
|-----------------------|---|
| <b>Product type</b>   | Socket<br>Flush-mounting  |
| <b>Series</b>         | PEW...PQ, PLUSO   |
| <b>N. of poles</b>    | 3 poles + N +  |
| <b>Clock position</b> | 4   |
| <b>Size</b>           | Socket fixing centre distance 60 x 60 mm  |
| <b>Specification</b>  | Straight  |

## Technical data

|                                |                   |
|--------------------------------|-------------------|
| <b>Current</b>                 | 16 A              |
| <b>Voltage</b>                 | 57/100 ÷ 75/130 V |
| <b>IP degree of protection</b> | IP67              |

## Further technical details

|   |                 |
|---|-----------------|
| <b>Weight</b>                                 | 203,00 g        |
| <b>Operating temperature range (min, max)</b> | -25°C ... +40°C |

## Material properties

|                              |  |
|------------------------------|--|
| <b>Colour</b>                | RAL 7035 grey, RAL 1021 yellow   |
| <b>RoHs conformity</b>       | Compliant with exemption 6(c): copper alloy containing up to 4% lead by weight |
| <b>China RoHs - EFUP</b>     | 50   |
| <b>REACH SVHC substances</b> | Yes<br>Lead  |
| <b>SCIP number</b>           | Ca7de37f-add8-4b77-9861-279c94903ade   |

## Approvals / Standards

|                           |                   |
|---------------------------|-------------------|
| <b>Reference standard</b> | EN 60309-1 and -2 |
|---------------------------|-------------------|

## General ordering information

|                   |               |
|-------------------|---------------|
| <b>EAN13 code</b> | 8015747072335 |
|-------------------|---------------|

## Packaging Information

|                              |                      |
|------------------------------|----------------------|
| <b>Packaging length</b>      | 285,00 mm            |
| <b>Packaging height</b>      | 170,00 mm            |
| <b>Packaging width</b>       | 190,00 mm            |
| <b>Packaging weight</b>      | 2,30 kg              |
| <b>Packaging volume</b>      | 9,21 dm <sup>3</sup> |
| <b>Packaging description</b> | Carton box           |
| <b>Packaging quantity</b>    | 10 Pcs               |
| <b>Packaging EAN code</b>    | 8015747072342        |

Part number

# PEW 1645 PQ



Catalogue drawings

(16 / 32A) PEW ... PQ

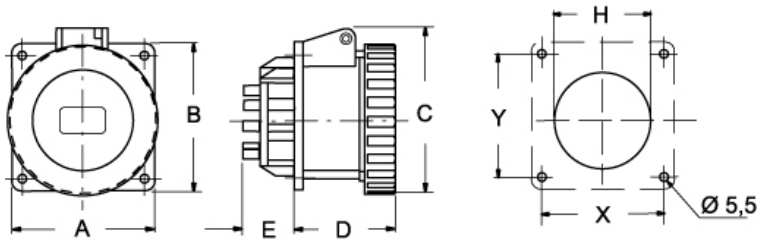

| PEW ... PQ      | A  | B  | C   | D  | E  | H    | X  | Y  |
|-----------------|----|----|-----|----|----|------|----|----|
| <b>16A</b> 2P+⊕ | 65 | 65 | 77  | 52 | 27 | 60   | 52 | 52 |
|                 | 65 | 65 | 85  | 52 | 27 | 61,5 | 52 | 52 |
|                 | 80 | 80 | 93  | 52 | 27 | 70   | 60 | 60 |
| <b>32A</b> 2P+⊕ | 80 | 80 | 98  | 62 | 28 | 68   | 60 | 60 |
|                 | 80 | 80 | 98  | 62 | 28 | 68   | 60 | 60 |
|                 | 80 | 80 | 105 | 62 | 28 | 73   | 60 | 60 |