

Part number

PEW 1644 PQF



Flush-mounting socket outlet, PLUSO series, 3 poles + PE, 4 h (yellow), 16 A, 100 ÷ 130 V, straight, with bigger flange

Product description		Material properties	
Product type	Socket Flush-mounting	Colour	RAL 7035 grey, RAL 1021 yellow
Series	PEW...PQF, PLUSO	RoHs conformity	Compliant with exemption 6(c): copper alloy containing up to 4% lead by weight
N. of poles	3 poles + 	China RoHs - EFUP	50
Clock position	4	REACH SVHC substances	Yes Lead
Size	Socket fixing centre distance 60 x 60 mm	SCIP number	Ca7de37f-add8-4b77-9861-279c94903ade
Specification	Straight, bigger flange	Approvals / Standards	
Technical data		Reference standard	EN 60309-1 and -2
Current	16 A	General ordering information	
Voltage	100 ÷ 130 V	EAN13 code	8015747072199
IP degree of protection	IP67	Packaging Information	
Further technical details		Packaging length	285,00 mm
Weight	150,00 g	Packaging height	170,00 mm
Operating temperature range (min, max)	-25°C ... +40°C	Packaging width	190,00 mm
		Packaging weight	1,60 kg
		Packaging volume	9,21 dm ³
		Packaging description	Carton box
		Packaging quantity	10 Pcs
		Packaging EAN code	8015747072205

Part number

PEW 1644 PQF



Catalogue drawings

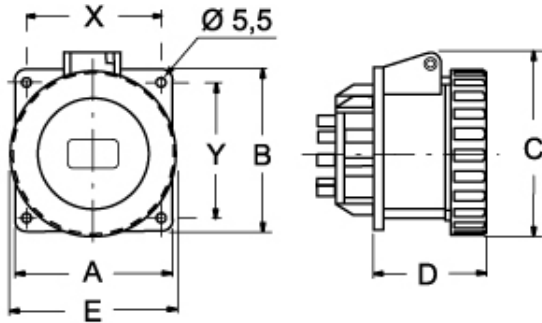

		A	B	C	D	E	X	Y
PQF 16 A	2P+⊖	80	80	--	52	70	60	60
	3P+⊖	80	80	--	52	78	60	60
PQ 16 A	2P+⊖	65	65	77	52	70	52	52
	3P+⊖	65	65	85	52	78	52	52
	3P+N+⊖	80	80	93	52	86	60	60
PQ 32 A	2P+⊖	80	80	98	62	92	60	60
	3P+⊖	80	80	98	62	92	60	60
	3P+N+⊖	80	80	105	62	100	60	60