

Part number

# PEW 12565 PQ



Flush-mounting socket outlet, PLUSO series, 3 poles + N + PE, 6 h (red), 125 A, 380 ÷ 415 V, straight

## Product description

<b>Product type</b>	Socket Flush-mounting
<b>Series</b>	PEW...PQ, PLUSO
<b>Connection type</b>	Screw terminal connection
<b>N. of poles</b>	3 poles + N + 
<b>Clock position</b>	6
<b>Specification</b>	Straight

## Technical data

<b>Current</b>	125 A
<b>Voltage</b>	380 ÷ 415 V
<b>IP degree of protection</b>	IP67

## Further technical details

<b>Weight</b>	1.700,00 g
<b>Operating temperature range (min, max)</b>	-25°C ... +40°C

## Material properties

<b>Colour</b>	RAL 7035 grey, RAL 3000 red
<b>RoHs conformity</b>	Compliant with exemption 6(c): copper alloy containing up to 4% lead by weight
<b>China RoHs - EFUP</b>	50
<b>REACH SVHC substances</b>	Yes Lead
<b>SCIP number</b>	Ca7de37f-add8-4b77-9861-279c94903ade

## Approvals / Standards

<b>Reference standard</b>	EN 60309-1 and -2
---------------------------	-------------------

## General ordering information

<b>EAN13 code</b>	8015747070560
-------------------	---------------

## Packaging Information

<b>Packaging length</b>	335,00 mm
<b>Packaging height</b>	320,00 mm
<b>Packaging width</b>	400,00 mm
<b>Packaging weight</b>	14,70 kg
<b>Packaging volume</b>	42,88 dm <sup>3</sup>
<b>Packaging description</b>	Carton box
<b>Packaging quantity</b>	8 Pcs
<b>Packaging EAN code</b>	8015747070577
<b>Sub-packaging weight</b>	1,84 kg
<b>Sub-packaging description</b>	Carton box
<b>Sub-packaging quantity</b>	1 Pcs
<b>Sub-packaging EAN barcode</b>	8015747070584

Part number

# PEW 12565 PQ



Catalogue drawings

(63 / 125A) PEW ... PQ

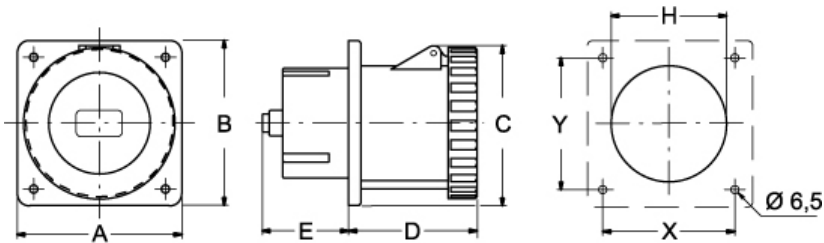

PEW ... PQ	A	B	C	D	E	H	X	Y
<b>63A</b> 2P+⊕	100	107	109	92	30	73	77	85
3P+⊕	100	107	109	92	30	73	77	85
3P+N+⊕	100	107	109	92	30	73	77	85
<b>125A</b> 2P+⊕	130	130	130	101	68	91	104	104
3P+⊕	130	130	130	101	68	91	104	104
3P+N+⊕	130	130	130	101	68	91	104	104