

Part number

PE 1695 SM



Wall-mounting plug, PLUSO series, 3 poles + N + PE, 9 h (blue), 16 A, 120/208 ÷ 144/250 V

Product description

Product type	Plug Wall-mounting
Series	PE...SM, PLUSO
N. of poles	3 poles + N + 
Clock position	9

Technical data

Current	16 A
Voltage	120/208 ÷ 144/250 V
IP degree of protection	IP44

Further technical details

Weight	191,00 g
Operating temperature range (min, max)	-25°C ... +40°C

Material properties

Colour	RAL 7035 grey, RAL 5015 blue
RoHs conformity	Compliant with exemption 6(c): copper alloy containing up to 4% lead by weight
China RoHs - EFUP	50
REACH SVHC substances	Yes Lead
SCIP number	Ca7de37f-add8-4b77-9861-279c94903ade

Approvals / Standards

Reference standard	EN 60309-1 and -2
---------------------------	-------------------

General ordering information

EAN13 code	8015747065801
-------------------	---------------

Packaging Information

Packaging length	340,00 mm
Packaging height	135,00 mm
Packaging width	200,00 mm
Packaging weight	1,96 kg
Packaging volume	9,18 dm ³
Packaging description	Carton box
Packaging quantity	10 Pcs
Packaging EAN code	8015747065818

Part number

PE 1695 SM



Catalogue drawings

(16 / 32A) PE ... SM

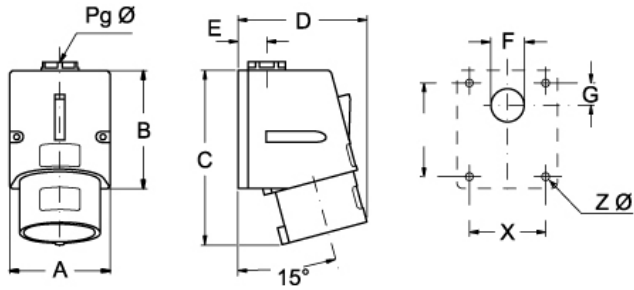

PE ... SM	A	B	C	D	E	F	G	X	Y	Z Ø	Pg Ø
16A 2P+⊕	70	82	115	75	20	23	16	53	65	4,5	16
3P+⊕	70	82	117	75	20	23	16	53	65	4,5	16
3P+N+⊕	70	82	121	90	20	23	16	53	65	4,5	16
32A 2P+⊕	86	104	145	95	24	29	17	61	79	6,5	21
3P+⊕	86	104	145	95	24	29	17	61	79	6,5	21
3P+N+⊕	86	104	147	95	24	29	17	61	79	6,5	21