

Part number

# MMP 06 CS25



Surface mounting housing, 830V series, with 4 pegs, M25 cable entry, size "77.27", with metal cover

## Product description

|                      |                          |
|----------------------|--------------------------|
| <b>Product type</b>  | Surface mounting housing |
| <b>Series</b>        | 830V                     |
| <b>Closing type</b>  | With 4 pegs              |
| <b>Size</b>          | Size 77.27               |
| <b>Cable entry</b>   | With cable entry<br>M25  |
| <b>Specification</b> | With metal cover         |

## Technical data

**IP degree of protection** IP65

## Further technical details

|   |                |
|---|----------------|
| <b>Weight</b>                                 | 312,00 g       |
| <b>Operating temperature range (min, max)</b> | -40°C...+125°C |

## Material properties

|                              |               |
|------------------------------|---------------|
| <b>Colour</b>                | RAL 7040 grey |
| <b>RoHs conformity</b>       | Compliant     |
| <b>China RoHs - EFUP</b>     | E             |
| <b>REACH SVHC substances</b> | No            |
| <b>Approvals / Standards</b> |               |
| <b>Certifications</b>        | DNV, BV       |
| <b>UL</b>                    | ECBT2         |
| <b>cUL</b>                   | ECBT8         |

## General ordering information

**EAN13 code** 8015747058612

## Packaging Information

|                                  |                   |
|----------------------------------|-------------------|
| <b>Sub-packaging weight</b>      | 1,56 kg           |
| <b>Sub-packaging description</b> | Plastic packaging |
| <b>Sub-packaging quantity</b>    | 5 Pcs             |
| <b>Sub-packaging EAN barcode</b> | 8015747108003     |

Part number

# MMP 06 CS25



Catalogue drawings

## CMP CMAP - MMP MMAP

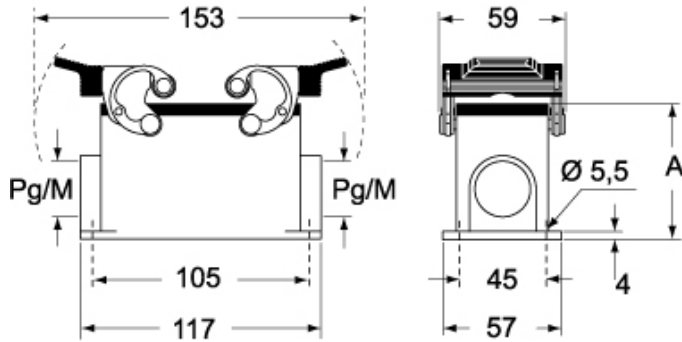

## CMP CS/CP CMAP CS/CP - MMP CS/CP MMAP CS/CP

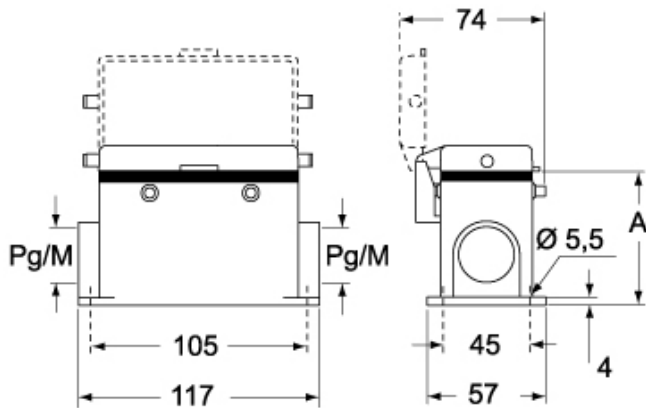

|                          | A  |
|--------------------------|----|
| <b>CMP / MMP</b>         | 63 |
| <b>CMAP / MMAP</b>       | 77 |
| <b>CMP CS / MMP CS</b>   | 63 |
| <b>CMAP CS / MMAP CS</b> | 77 |
| <b>CMP CP / MMP CP</b>   | 63 |
| <b>CMAP CP / MMAP CP</b> | 77 |