

Part number

# MKAXS IAP25



Angled Bulkhead mounting housing, EMC series, with 1 lever, M25 cable entry, size "21.21"

## Product description

|                     |                                  |
|---------------------|----------------------------------|
| <b>Product type</b> | Angled bulkhead mounting housing |
| <b>Series</b>       | EMC                              |
| <b>Closing type</b> | With 1 lever                     |
| <b>Size</b>         | Size "21.21"                     |
| <b>Cable entry</b>  | With cable entry<br>M25          |

## Technical data

**IP degree of protection** IP44 - IP66 / IP67 / IP69 with CKR 65 (D)

## Further technical details

|   |                |
|---|----------------|
| <b>Weight</b>                                 | 102,50 g       |
| <b>Operating temperature range (min, max)</b> | -40°C...+125°C |

## Material properties

|                              |  |
|------------------------------|--|
| <b>Main material</b>         | Zinc die-cast  |
| <b>Other materials</b>       | Lever: Stainless steel<br>Gasket: Conductive elastomer |
| <b>Colour</b>                | RAL 7040 grey  |
| <b>RoHs conformity</b>       | Compliant  |
| <b>China RoHs - EFUP</b>     | E  |
| <b>REACH SVHC substances</b> | No   |

## Approvals / Standards

|                       |         |
|-----------------------|---------|
| <b>Certifications</b> | DNV, BV |
| <b>UL</b>             | ECBT2   |
| <b>cUL</b>            | ECBT8   |

## General ordering information

|                   |               |
|-------------------|---------------|
| <b>EAN13 code</b> | 8015747253666 |
| <b>eCl@ss 8.1</b> | 27440202      |
| <b>ETIM 7.0</b>   | EC000437      |

## Packaging Information

|                                  |                      |
|----------------------------------|----------------------|
| <b>Sub-packaging length</b>      | 210,00 mm            |
| <b>Sub-packaging height</b>      | 40,00 mm             |
| <b>Sub-packaging width</b>       | 175,00 mm            |
| <b>Sub-packaging weight</b>      | 1,03 kg              |
| <b>Sub-packaging volume</b>      | 1,47 dm <sup>3</sup> |
| <b>Sub-packaging description</b> | Carton box           |
| <b>Sub-packaging quantity</b>    | 10 Pcs               |
| <b>Sub-packaging EAN barcode</b> | 8015747253680        |

Part number

# MKAXS IAP25



Catalogue drawings

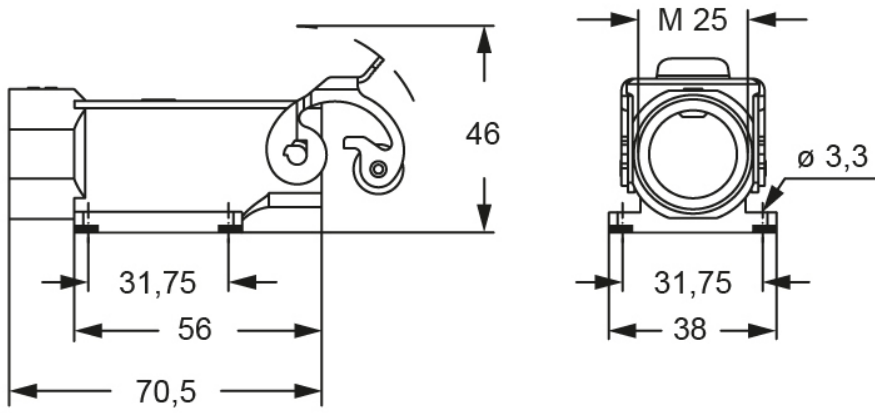

Catalogue drawings

