

Part number

# CZCW 25 L



Cover, W-TYPE series, with 2 pegs, size "66.16", with eyelet

#### Product description

<b>Product type</b>	Cover
<b>Series</b>	W-TYPE
<b>Closing type</b>	With 2 pegs
<b>Size</b>	Size 66.16
<b>Specification</b>	With eyelet

#### Technical data

<b>IP degree of protection</b>	IP65
--------------------------------	------

#### Further technical details

<b>Weight</b>	33,00 g
<b>Operating temperature range (min, max)</b>	-40°C...+125°C

#### Material properties

<b>Main material</b>	Aluminium die-cast
<b>Other materials</b>	Gasket: FKM
<b>Colour</b>	RAL 9005 black
<b>RoHs conformity</b>	Compliant
<b>China RoHs - EFUP</b>	E
<b>REACH SVHC substances</b>	No

#### Approvals / Standards

<b>Certifications</b>	DNV, BV
<b>UL</b>	ECBT2
<b>cUL</b>	ECBT8

#### General ordering information

<b>EAN13 code</b>	8015747043977
<b>eCl@ss 8.1</b>	27440208
<b>ETIM 7.0</b>	EC002314

#### Packaging Information

<b>Sub-packaging length</b>	118,00 mm
<b>Sub-packaging height</b>	32,00 mm
<b>Sub-packaging width</b>	76,00 mm
<b>Sub-packaging weight</b>	0,17 kg
<b>Sub-packaging volume</b>	0,29 dm <sup>3</sup>
<b>Sub-packaging description</b>	Carton tray
<b>Sub-packaging quantity</b>	5 Pcs
<b>Sub-packaging EAN barcode</b>	8015747043984

Part number

# CZCW 25 L



## Catalogue drawings

CZIW L

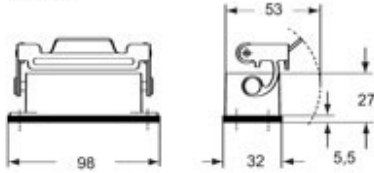

CZAPW L MZAPW L

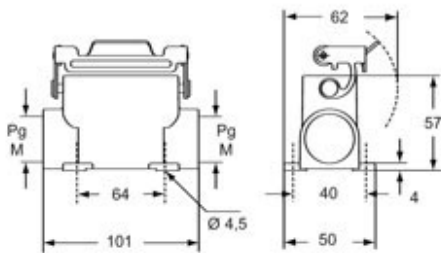

CZCW L

