

Part number

CHPT 10.4 LS



Surface mounting housing, C-TYPE series, with 1 lever, 1/2" NPT cable entry, size "57.27", with metal cover

Product description		Material properties	
Product type	Surface mounting housing	Other materials	Lever: Stainless steel, polyamide (PA) Gasket: NBR
Series	C-TYPE	Colour	RAL 7040 grey
Closing type	With 1 lever	RoHs conformity	Compliant
Size	Size 57.27	China RoHs - EFUP	E
Cable entry	With cable entry 1/2" NPT	REACH SVHC substances	No
Specification	With metal cover	Approvals / Standards	
Technical data		Certifications	DNV, BV
IP degree of protection	IP65 / IP66 / IP69	UL	ECBT2
Further technical details		cUL	ECBT8
Weight	295,00 g	General ordering information	
Operating temperature range (min, max)	-40°C...+125°C	EAN13 code	8015747114288
		Packaging Information	
		Packaging length	475,00 mm
		Packaging height	170,00 mm
		Packaging width	150,00 mm
		Packaging weight	3,36 kg
		Packaging volume	12,11 dm ³
		Packaging description	Carton box
		Packaging quantity	10 Pcs
		Packaging EAN code	8015747114417
		Sub-packaging weight	1,68 kg
		Sub-packaging description	Plastic packaging
		Sub-packaging quantity	5 Pcs
		Sub-packaging EAN barcode	8015747114424

Part number

CHPT 10.4 LS



Catalogue drawings

CHP L - CAP L MHP L - MAP L

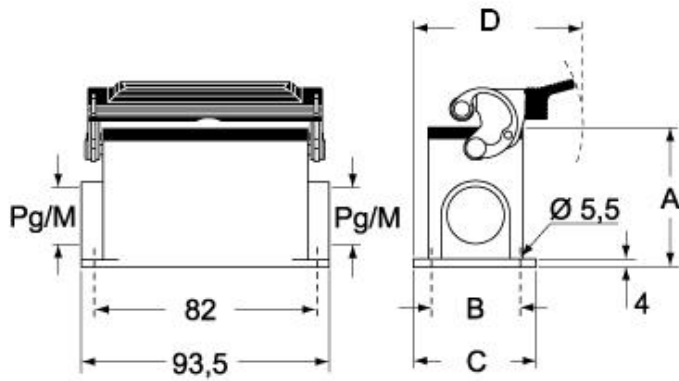

CHP LS - CAP LS MHP LS - MAP LS

