

Part number

# C30MA 70



Male crimp contact, C30 series, 300 A, turned silver plated, wire cross section 70 mm<sup>2</sup>, AWG 2/0

#### Product description

<b>Product type</b>	Crimp contact
<b>Series</b>	C30
<b>Gender</b>	Male

#### Technical data

<b>Current</b>	300 A
<b>Wire cross-section</b>	70,00 mm <sup>2</sup>
<b>Contact type</b>	Turned silver plated

#### Further technical details

<b>Contact resistance</b>	≤ 0,2 mΩ
<b>Weight</b>	40,80 g
<b>Conductors stripping length</b>	22,5 mm

#### Material properties

<b>Main material</b>	Copper alloy
<b>RoHs conformity</b>	Compliant with exemption 6(c): copper alloy containing up to 4% lead by weight
<b>China RoHs - EFUP</b>	50
<b>REACH SVHC substances</b>	Yes Lead

#### General ordering information

<b>EAN13 code</b>	8015747290388
-------------------	---------------

#### Packaging Information

<b>Packaging length</b>	112,00 mm
<b>Packaging height</b>	95,00 mm
<b>Packaging width</b>	117,00 mm
<b>Packaging volume</b>	1,24 dm <sup>3</sup>
<b>Packaging description</b>	Carton box
<b>Packaging quantity</b>	40 Pcs
<b>Packaging EAN code</b>	8015747290395
<b>Sub-packaging description</b>	Plastic box
<b>Sub-packaging quantity</b>	5 Pcs
<b>Sub-packaging EAN barcode</b>	8015747290401

Part number

# C30MA 70



Catalogue drawings

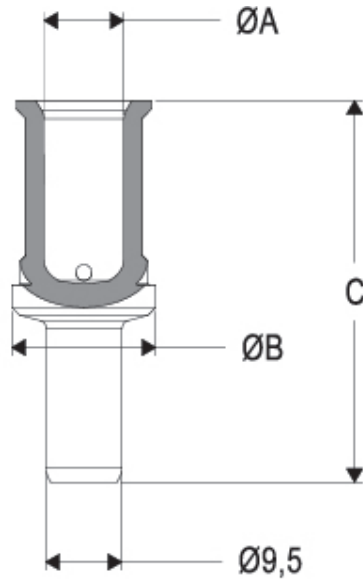

## C30MA contacts

conductor section (mm <sup>2</sup> )	conductor slot ø A (mm)	ø B (mm)	C (mm)	conductor stripping length (mm)
16	5,5	18	42,7	19
25	7	18	42,7	19
35	8,2	18	43,7	20
50	10	18	49,2	22,5
70	11,5	18	49,2	22,5
95	13,5	21	49,2	22,5
120	15,5	21	49,2	22,5