

Part number

# BK 1625



Interlocked switched socket-outlet, BK series, 3 poles + N + PE, 2 h (green), 16 A, > 50 V, sectionable fuse carrier 10 x 38 mm

| Product description                            |   |
|--|---|
| <b>Product type</b>                            | Interlocked switched socket-outlet  |
| <b>Series</b>                                  | BK  |
| <b>N. of poles</b>                             | 3 poles + N +  |
| <b>Clock position</b>                          | 2   |
| <b>Specification</b>                           | Sectionable fuse carrier 10 x 38 mm   |
| Technical data                                 |   |
| <b>Current</b>                                 | 16 A  |
| <b>Voltage</b>                                 | > 50 V  |
| <b>IP degree of protection</b>                 | IP67  |
| Further technical details                      |   |
| <b>Weight</b>                                  | 1.365,00 g  |
| <b>Operating temperature range (min, max)</b>  | -25°C ... +40°C   |
| <b>IK rating (impact degree of protection)</b> | IK10  |

| Material properties              |  |
|----------------------------------|--|
| <b>Colour</b>                    | RAL 7035 grey, RAL 6017 green  |
| <b>RoHs conformity</b>           | Compliant with exemption 6(c): copper alloy containing up to 4% lead by weight |
| <b>China RoHs - EFUP</b>         | 50   |
| <b>REACH SVHC substances</b>     | Yes<br>Lead  |
| <b>SCIP number</b>               | F6799547-ab84-42f2-938f-233ba663766d   |
| Approvals / Standards            |  |
| <b>Reference standard</b>        | EN 60309-1, -2 e -4  |
| General ordering information     |  |
| <b>EAN13 code</b>                | 8015747147118  |
| Packaging Information            |  |
| <b>Sub-packaging length</b>      | 116,00 mm  |
| <b>Sub-packaging height</b>      | 130,00 mm  |
| <b>Sub-packaging width</b>       | 230,00 mm  |
| <b>Sub-packaging weight</b>      | 1,37 kg  |
| <b>Sub-packaging volume</b>      | 3,47 dm <sup>3</sup>   |
| <b>Sub-packaging description</b> | Carton box   |
| <b>Sub-packaging quantity</b>    | 1 Pcs  |
| <b>Sub-packaging EAN barcode</b> | 8015747172318  |

Part number

# BK 1625



Catalogue drawings

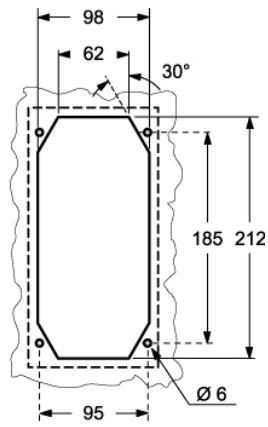
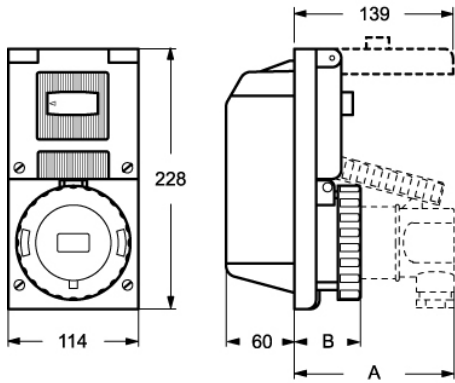

| BK  |            | A   | B  |
|-----|------------|-----|----|
| 16A | 2P + ⊕     | 105 | 50 |
|     | 3P + ⊕     | 105 | 50 |
|     | 3P + N + ⊕ | 110 | 50 |
| 32A | 2P + ⊕     | 140 | 58 |
|     | 3P + ⊕     | 140 | 58 |
|     | 3P + N + ⊕ | 140 | 58 |