

Part number

TM 1665 IT



Interlocked switched socket-outlet, TM series,
3 poles + N + PE, 6 h (red), 16 A, 200/346 ÷
240/415 V, E16 fuse carrier, with base box

Product description		Material properties	
Product type	Interlocked switched socket-outlet	Colour	RAL 7012 grey, RAL 3000 red
Series	TM.. IT		Compliant with exemption 6(c): copper alloy containing up to 4% lead by weight
N. of poles	3 poles + N + 	RoHs conformity	6(c): copper alloy containing up to 4% lead by weight
Clock position	6	China RoHs - EFUP	50
Size	115 x 450 x 18 mm	REACH SVHC substances	Yes Lead
Specification	E16 fuse carrier With base box	SCIP number	Ce861c8d-b979-403b-96d9-80aef6dc281d
Technical data		Approvals / Standards	
Current	16 A	Reference standard	EN 60309-1, -2 e -4
Voltage	200/346 ÷ 240/415 V	General ordering information	
IP degree of protection	IP66 / IP67	EAN13 code	8015747090179
Further technical details		Packaging Information	
Weight	1.720,00 g	Packaging weight	15,58 kg
Operating temperature range (min, max)	-25°C ... +40°C	Packaging volume	55,44 dm ³
UL 94 flammability rating	V-2	Packaging description	Carton box
IK rating (impact degree of protection)	IK10	Packaging quantity	9 Pcs
		Packaging EAN code	8015747090186
		Sub-packaging weight	1,73 kg
		Sub-packaging description	Plastic packaging
		Sub-packaging quantity	1 Pcs
		Sub-packaging EAN barcode	8015747090193

Part number

TM 1665 IT



Catalogue drawings

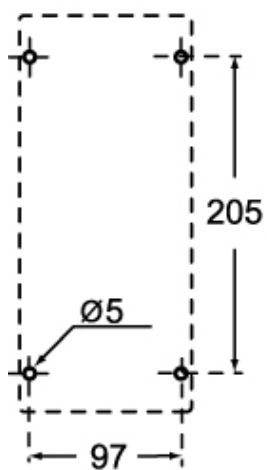
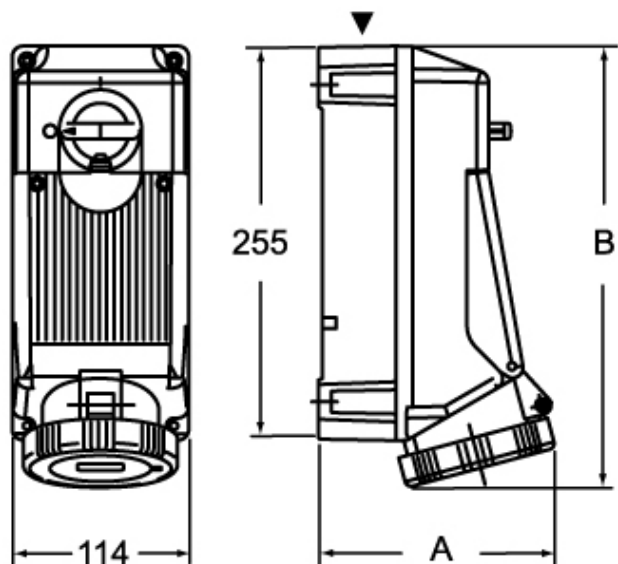

	A	B
2P+⊕	133	276
3P+⊕	135	276
3P+N+⊕	140	277