

Part number

TM 1663 IT



Interlocked switched socket-outlet, TM series,
2 poles + PE, 6 h (blue), 16 A, 200 ÷ 250 V,
E16 fuse carrier, with base box

Product description

Product type	Interlocked switched socket-outlet
Series	TM.. IT
N. of poles	2 poles + 
Clock position	6
Size	115 x 450 x 18 mm
Specification	E16 fuse carrier With base box

Technical data

Current	16 A
Voltage	200 ÷ 250 V
IP degree of protection	IP66 / IP67

Further technical details

Weight	1.590,00 g
Operating temperature range (min, max)	-25°C ... +40°C
UL 94 flammability rating	V-2
IK rating (impact degree of protection)	IK10

Material properties

Colour	RAL 7012 grey, RAL 5015 blue
RoHs conformity	Compliant with exemption 6(c): copper alloy containing up to 4% lead by weight
China RoHs - EFUP	50
REACH SVHC substances	Yes Lead
SCIP number	Ce861c8d-b979-403b-96d9-80aef6dc281d

Approvals / Standards

Reference standard	EN 60309-1, -2 e -4
---------------------------	---------------------

General ordering information

EAN13 code	8015747089814
-------------------	---------------

Packaging Information

Packaging weight	14,80 kg
Packaging volume	52,36 dm ³
Packaging description	Carton box
Packaging quantity	9 Pcs
Packaging EAN code	8015747089821
Sub-packaging weight	1,64 kg
Sub-packaging description	Plastic packaging
Sub-packaging quantity	1 Pcs
Sub-packaging EAN barcode	8015747089838

Part number

TM 1663 IT



Catalogue drawings

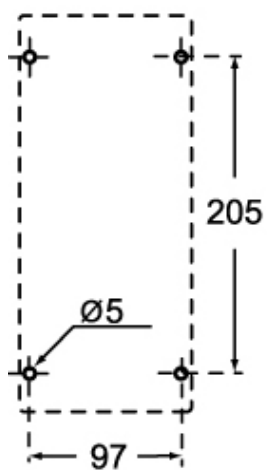

	A	B
2P+ \oplus	133	276
3P+ \oplus	135	276
3P+N+ \oplus	140	277