

Part number

SQE 1675.5



Interlocked switched socket-outlet, SQE series, 3 poles + N + PE, 7 h (black), 16 A, 277/480 ÷ 288/500 V, without fuse-carrier

Product description

Product type	Interlocked switched socket-outlet
Series	SQE
N. of poles	3 poles + N + 
Clock position	7
Specification	Without fuse-carrier

Technical data

Current	16 A
Voltage	277/480 ÷ 288/500 V
IP degree of protection	IP55

Further technical details

Weight	590,00 g
Operating temperature range (min, max)	-25°C ... +40°C
IK rating (impact degree of protection)	IK08

Material properties

Colour	RAL 7035 grey, RAL 9005 black
---------------	-------------------------------

Approvals / Standards

Reference standard	EN 60309-1, -2 e -4
---------------------------	---------------------

General ordering information

EAN13 code	8015747086059
-------------------	---------------

Packaging Information

Sub-packaging weight	0,59 kg
Sub-packaging description	Carton box
Sub-packaging quantity	1 Pcs
Sub-packaging EAN barcode	8015747109314

Part number

SQE 1675.5



Catalogue drawings

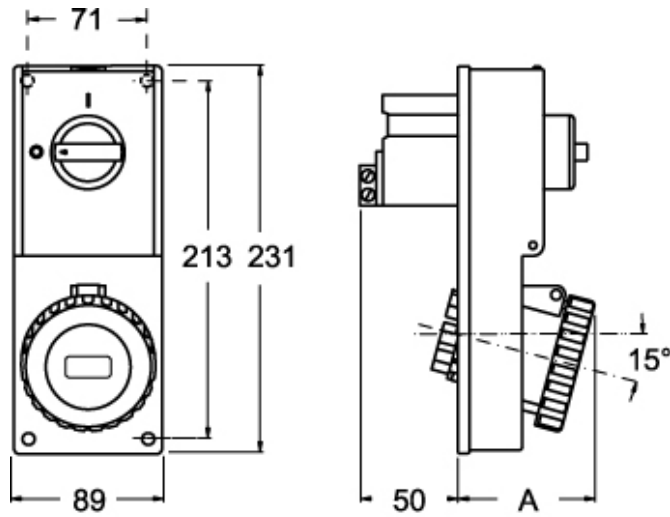

Catalogue drawings



SQE.5		A
16A	2P+⊕	67
	3P+⊕	67
	3P+N+⊕	70