

Part number

# RDM2D 2.5

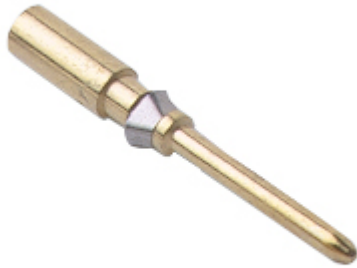

Male crimp contact, RD series, turned gold plated, wire cross section 2,5 mm<sup>2</sup>, AWG 14, HNM - High Number of Matings version

#### Product description

<b>Product type</b>	Crimp contact
<b>Series</b>	RD
<b>Gender</b>	Male
<b>Specification</b>	HNM - High Number of Matings version

#### Technical data

<b>Current</b>	10 A
<b>Wire cross-section</b>	2,50 mm <sup>2</sup>
<b>AWG size</b>	14
<b>Contact type</b>	Turned gold plated

#### Further technical details

<b>Weight</b>	0,40 g
---------------	--------

#### Material properties

<b>RoHs conformity</b>	Compliant with exemption 6(c): copper alloy containing up to 4% lead by weight
<b>China RoHs - EFUP</b>	50
<b>REACH SVHC substances</b>	Yes Lead
<b>SCIP number</b>	C0979fba-9907-458f-a94a-db781440f273

#### Approvals / Standards

<b>UL</b>	ECBT2
-----------	-------

#### General ordering information

<b>EAN13 code</b>	8015747255530
<b>eCl@ss 8.1</b>	27440204
<b>ETIM 7.0</b>	EC000796

#### Packaging Information

<b>Packaging length</b>	112,00 mm
<b>Packaging height</b>	95,00 mm
<b>Packaging width</b>	117,00 mm
<b>Packaging weight</b>	0,72 kg
<b>Packaging volume</b>	1,24 dm <sup>3</sup>
<b>Packaging description</b>	Carton box
<b>Packaging quantity</b>	800 Pcs
<b>Packaging EAN code</b>	8015747258814
<b>Sub-packaging length</b>	50,00 mm
<b>Sub-packaging height</b>	44,00 mm
<b>Sub-packaging width</b>	50,00 mm
<b>Sub-packaging weight</b>	0,09 kg
<b>Sub-packaging volume</b>	0,11 dm <sup>3</sup>
<b>Sub-packaging description</b>	Plastic box
<b>Sub-packaging quantity</b>	100 Pcs
<b>Sub-packaging EAN barcode</b>	8015747258807

Part number

# RDM2D 2.5



Catalogue drawings

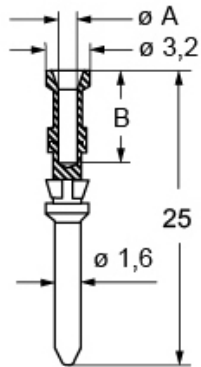

### RDF2D and RDM2D contacts

conductor cross-sectional area mm <sup>2</sup>	conductor slot $\varnothing A$ (mm)	conductor stripping length $B$ (mm)
0,14-0,37	0,9	8
0,5	1,1	8
0,75	1,3	8
1,0	1,45	8
1,5	1,8	8
2,5	2,2	6