

Part number

# PEW 3293 PQ



Flush-mounting socket outlet, PLUSO series, 2 poles + PE, 9 h (red), 32 A, 380 ÷ 415 V, straight

Product description		Material properties	
<b>Product type</b>	Socket Flush-mounting	<b>Colour</b>	RAL 7035 grey, RAL 3000 red
<b>Series</b>	PEW...PQ, PLUSO	<b>RoHs conformity</b>	Compliant with exemption 6(c): copper alloy containing up to 4% lead by weight
<b>N. of poles</b>	2 poles + 	<b>China RoHs - EFUP</b>	50
<b>Clock position</b>	9	<b>REACH SVHC substances</b>	Yes Lead
<b>Size</b>	Socket fixing centre distance 60 x 60 mm	<b>SCIP number</b>	Ca7de37f-add8-4b77-9861-279c94903ade
<b>Specification</b>	Straight	Approvals / Standards	
Technical data		<b>Reference standard</b>	EN 60309-1 and -2
<b>Current</b>	32 A	General ordering information	
<b>Voltage</b>	380 ÷ 415 V	<b>EAN13 code</b>	8015747076067
<b>IP degree of protection</b>	IP67	Packaging Information	
Further technical details		<b>Packaging length</b>	330,00 mm
<b>Weight</b>	223,00 g	<b>Packaging height</b>	175,00 mm
<b>Operating temperature range (min, max)</b>	-25°C ... +40°C	<b>Packaging width</b>	295,00 mm
		<b>Packaging weight</b>	2,50 kg
		<b>Packaging volume</b>	17,04 dm <sup>3</sup>
		<b>Packaging description</b>	Carton box
		<b>Packaging quantity</b>	10 Pcs
		<b>Packaging EAN code</b>	8015747076074

Part number

# PEW 3293 PQ



Catalogue drawings

(16 / 32A) PEW ... PQ

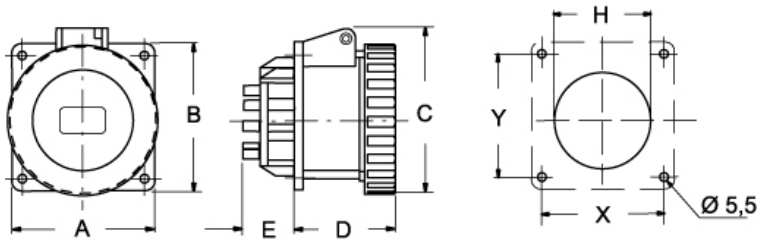

PEW ... PQ	A	B	C	D	E	H	X	Y
<b>16A</b> 2P+⊕	65	65	77	52	27	60	52	52
3P+⊕	65	65	85	52	27	61,5	52	52
3P+N+⊕	80	80	93	52	27	70	60	60
<b>32A</b> 2P+⊕	80	80	98	62	28	68	60	60
3P+⊕	80	80	98	62	28	68	60	60
3P+N+⊕	80	80	105	62	28	73	60	60