

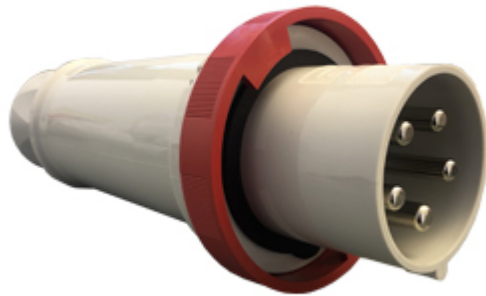

Part number

PEW 12565 SV



Mobile plug, PLUSO series, 3 poles + N + PE, 6 h (red), 125 A, 380 ÷ 415 V, straight

Product description

| | |
|------------------------|---|
| Product type | Plug Mobile |
| Series | PEW...SV, PLUSO |
| Connection type | Screw terminal connection |
| N. of poles | 3 poles + N +  |
| Clock position | 6 |
| Specification | Straight |

Technical data

| | |
|--------------------------------|-------------|
| Current | 125 A |
| Voltage | 380 ÷ 415 V |
| IP degree of protection | IP67 |

Further technical details

| | |
|---|-----------------|
| Weight | 1.785,00 g |
| Operating temperature range (min, max) | -25°C ... +40°C |

Material properties

| | |
|------------------------------|--|
| Colour | RAL 7035 grey, RAL 3000 red |
| RoHs conformity | Compliant with exemption 6(c): copper alloy containing up to 4% lead by weight |
| China RoHs - EFUP | 50 |
| REACH SVHC substances | Yes Lead |
| SCIP number | Ca7de37f-add8-4b77-9861-279c94903ade |

Approvals / Standards

| | |
|---------------------------|-------------------|
| Reference standard | EN 60309-1 and -2 |
|---------------------------|-------------------|

General ordering information

| | |
|-------------------|---------------|
| EAN13 code | 8015747070669 |
|-------------------|---------------|

Packaging Information

| | |
|----------------------------------|-----------------------|
| Packaging length | 330,00 mm |
| Packaging height | 170,00 mm |
| Packaging width | 230,00 mm |
| Packaging weight | 3,87 kg |
| Packaging volume | 12,90 dm ³ |
| Packaging description | Carton box |
| Packaging quantity | 2 Pcs |
| Packaging EAN code | 8015747192835 |
| Sub-packaging weight | 1,94 kg |
| Sub-packaging description | Plastic packaging |
| Sub-packaging quantity | 1 Pcs |
| Sub-packaging EAN barcode | 8015747070683 |

Part number

PEW 12565 SV



Catalogue drawings

(63 / 125A) PEW ... SV

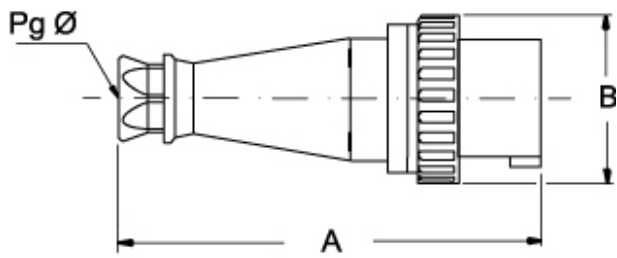

| PEW ... SV | A | B | Pg Ø |
|------------------|-------|-----|--------|
| 63A 2P+⊕ | 264,5 | 112 | 36 |
| 3P+⊕ | 264,5 | 112 | 36 |
| 3P+N+⊕ | 264,5 | 112 | 36 |
| 125A 2P+⊕ | 310 | 130 | 2" gas |
| 3P+⊕ | 310 | 130 | 2" gas |
| 3P+N+⊕ | 310 | 130 | 2" gas |