

Part number

PE 3224 PQ



Flush-mounting socket outlet, PLUSO series, 3 poles + PE, 2 h (green), 32 A, > 50 V, straight

Product description

| | |
|-----------------------|---|
| Product type | Socket Flush-mounting |
| Series | PE...PQ, PLUSO |
| N. of poles | 3 poles +  |
| Clock position | 2 |
| Specification | Straight |

Technical data

| | |
|--------------------------------|--------|
| Current | 32 A |
| Voltage | > 50 V |
| IP degree of protection | IP44 |

Further technical details

| | |
|---|-----------------|
| Weight | 187,00 g |
| Operating temperature range (min, max) | -25°C ... +40°C |

Material properties

| | |
|------------------------------|--|
| Colour | RAL 7035 grey, RAL 6017 green |
| RoHs conformity | Compliant with exemption 6(c): copper alloy containing up to 4% lead by weight |
| China RoHs - EFUP | 50 |
| REACH SVHC substances | Yes Lead |
| SCIP number | Ca7de37f-add8-4b77-9861-279c94903ade |

Approvals / Standards

| | |
|---------------------------|-------------------|
| Reference standard | EN 60309-1 and -2 |
|---------------------------|-------------------|

General ordering information

| | |
|-------------------|---------------|
| EAN13 code | 8015747066297 |
|-------------------|---------------|

Packaging Information

| | |
|------------------------------|----------------------|
| Packaging length | 285,00 mm |
| Packaging height | 170,00 mm |
| Packaging width | 190,00 mm |
| Packaging weight | 2,09 kg |
| Packaging volume | 9,21 dm ³ |
| Packaging description | Carton box |
| Packaging quantity | 10 Pcs |
| Packaging EAN code | 8015747066303 |

Part number

PE 3224 PQ



Catalogue drawings

(16 / 32A) PE ... PQ

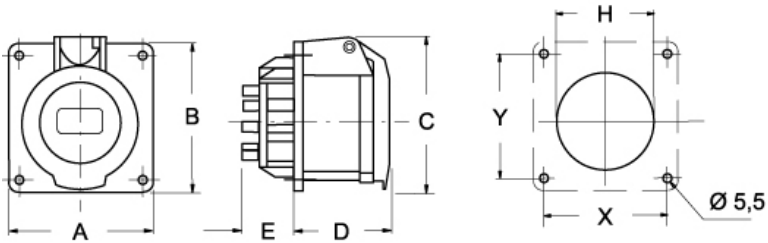

| PE ... PQ | A | B | C | D | E | H | X | Y |
|-----------------|----|----|----|----|----|------|----|----|
| 16A 2P+⊖ | 65 | 65 | 71 | 52 | 27 | 60 | 52 | 52 |
| | 65 | 65 | 75 | 53 | 27 | 61,5 | 52 | 52 |
| | 80 | 80 | 86 | 53 | 27 | 70 | 60 | 60 |
| 32A 2P+⊖ | 80 | 80 | 87 | 62 | 28 | 68 | 60 | 60 |
| | 80 | 80 | 87 | 62 | 28 | 68 | 60 | 60 |
| | 80 | 80 | 92 | 62 | 28 | 73 | 60 | 60 |