

Part number

# PE 1675 SM



Wall-mounting plug, PLUSO series, 3 poles + N + PE, 7 h (black), 16 A, 277/480 ÷ 288/500 V

| Product description                           |   | Material properties          |   |
|---|---|------------------------------|---|
| <b>Product type</b>                           | Plug<br>Wall-mounting   | <b>Colour</b>                | RAL 7035 grey, RAL 9005 black   |
| <b>Series</b>                                 | PE...SM, PLUSO  | <b>RoHs conformity</b>       | Compliant with exemption<br>6(c): copper alloy containing up to 4% lead by weight |
| <b>N. of poles</b>                            | 3 poles + N +  | <b>China RoHs - EFUP</b>     | 50  |
| <b>Clock position</b>                         | 7   | <b>REACH SVHC substances</b> | Yes<br>Lead   |
| Technical data                                |   | <b>SCIP number</b>           | Ca7de37f-add8-4b77-9861-279c94903ade  |
| <b>Current</b>                                | 16 A  | Approvals / Standards        |   |
| <b>Voltage</b>                                | 277/480 ÷ 288/500 V   | <b>Reference standard</b>    | EN 60309-1 and -2   |
| <b>IP degree of protection</b>                | IP44  | General ordering information |   |
| Further technical details                     |   | <b>EAN13 code</b>            | 8015747065214   |
| <b>Weight</b>                                 | 183,00 g  | Packaging Information        |   |
| <b>Operating temperature range (min, max)</b> | -25°C ... +40°C   | <b>Packaging length</b>      | 340,00 mm   |
|   |   | <b>Packaging height</b>      | 135,00 mm   |
|   |   | <b>Packaging width</b>       | 200,00 mm   |
|   |   | <b>Packaging weight</b>      | 1,95 kg   |
|   |   | <b>Packaging volume</b>      | 9,18 dm <sup>3</sup>  |
|   |   | <b>Packaging description</b> | Carton box  |
|   |   | <b>Packaging quantity</b>    | 10 Pcs  |
|   |   | <b>Packaging EAN code</b>    | 8015747065221   |

Part number

# PE 1675 SM



Catalogue drawings

(16 / 32A) PE ... SM

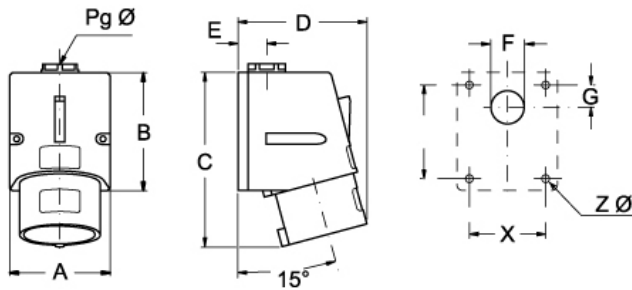

| PE ... SM       | A  | B   | C   | D  | E  | F  | G  | X  | Y  | Z Ø | Pg Ø |
|-----------------|----|-----|-----|----|----|----|----|----|----|-----|------|
| <b>16A</b> 2P+⊕ | 70 | 82  | 115 | 75 | 20 | 23 | 16 | 53 | 65 | 4,5 | 16   |
| 3P+⊕            | 70 | 82  | 117 | 75 | 20 | 23 | 16 | 53 | 65 | 4,5 | 16   |
| 3P+N+⊕          | 70 | 82  | 121 | 90 | 20 | 23 | 16 | 53 | 65 | 4,5 | 16   |
| <b>32A</b> 2P+⊕ | 86 | 104 | 145 | 95 | 24 | 29 | 17 | 61 | 79 | 6,5 | 21   |
| 3P+⊕            | 86 | 104 | 145 | 95 | 24 | 29 | 17 | 61 | 79 | 6,5 | 21   |
| 3P+N+⊕          | 86 | 104 | 147 | 95 | 24 | 29 | 17 | 61 | 79 | 6,5 | 21   |