

Part number

PE 1665 SM



Wall-mounting plug, PLUSO series, 3 poles + N + PE, 6 h (red), 16 A, 380 ÷ 415 V

Product description		Material properties	
Product type	Plug Wall-mounting	Colour	RAL 7035 grey, RAL 3000 red
Series	PE...SM, PLUSO	RoHs conformity	Compliant with exemption 6(c): copper alloy containing up to 4% lead by weight
Connection type	Screw terminal connection	China RoHs - EFUP	50
N. of poles	3 poles + N + 	REACH SVHC substances	Yes Lead
Clock position	6	SCIP number	Ca7de37f-add8-4b77-9861-279c94903ade
Technical data		Approvals / Standards	
Current	16 A	Reference standard	EN 60309-1 and -2
Voltage	380 ÷ 415 V	General ordering information	
IP degree of protection	IP44	EAN13 code	8015747064873
Further technical details		Packaging Information	
Weight	183,00 g	Packaging length	340,00 mm
Operating temperature range (min, max)	-25°C ... +40°C	Packaging height	135,00 mm
		Packaging width	200,00 mm
		Packaging weight	2,01 kg
		Packaging volume	9,18 dm ³
		Packaging description	Carton box
		Packaging quantity	10 Pcs
		Packaging EAN code	8015747064880

Part number

PE 1665 SM



Catalogue drawings

(16 / 32A) PE ... SM

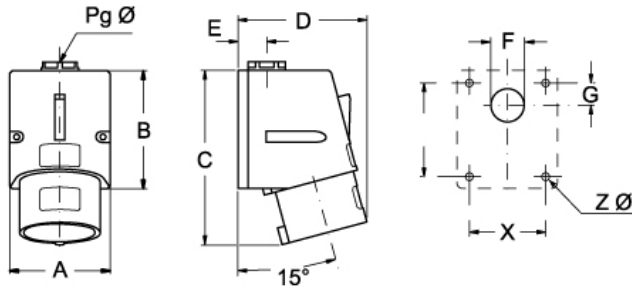

PE ... SM	A	B	C	D	E	F	G	X	Y	Z Ø	Pg Ø	
16A	2P+⊕	70	82	115	75	20	23	16	53	65	4,5	16
	3P+⊕	70	82	117	75	20	23	16	53	65	4,5	16
	3P+N+⊕	70	82	121	90	20	23	16	53	65	4,5	16
32A	2P+⊕	86	104	145	95	24	29	17	61	79	6,5	21
	3P+⊕	86	104	145	95	24	29	17	61	79	6,5	21
	3P+N+⊕	86	104	147	95	24	29	17	61	79	6,5	21