

Part number

# PE 1643 SA



Mobile plug, PLUSO series, 2 poles + PE, 4 h (yellow), 16 A, 100 ÷ 130 V, angled

| Product description                           |   | Material properties              |   |
|---|---|----------------------------------|---|
| <b>Product type</b>                           | Plug<br>Mobile  | <b>Colour</b>                    | RAL 7035 grey, RAL 1021 yellow  |
| <b>Series</b>                                 | PE...SA, PLUSO  | <b>RoHs conformity</b>           | Compliant with exemption<br>6(c): copper alloy containing up to 4% lead by weight |
| <b>N. of poles</b>                            | 2 poles +  | <b>China RoHs - EFUP</b>         | 50  |
| <b>Clock position</b>                         | 4   | <b>REACH SVHC substances</b>     | Yes<br>Lead   |
| <b>Specification</b>                          | Angled  | <b>SCIP number</b>               | Ca7de37f-add8-4b77-9861-279c94903ade  |
| Technical data                                |   | Approvals / Standards            |   |
| <b>Current</b>                                | 16 A  | <b>Reference standard</b>        | EN 60309-1 and -2   |
| <b>Voltage</b>                                | 100 ÷ 130 V   | General ordering information     |   |
| <b>IP degree of protection</b>                | IP44  | <b>EAN13 code</b>                | 8015747063838   |
| Further technical details                     |   | Packaging Information            |   |
| <b>Weight</b>                                 | 99,00 g   | <b>Sub-packaging length</b>      | 140,00 mm   |
| <b>Operating temperature range (min, max)</b> | -25°C ... +40°C   | <b>Sub-packaging height</b>      | 135,00 mm   |
|   |   | <b>Sub-packaging width</b>       | 235,00 mm   |
|   |   | <b>Sub-packaging weight</b>      | 0,99 kg   |
|   |   | <b>Sub-packaging volume</b>      | 4,44 dm <sup>3</sup>  |
|   |   | <b>Sub-packaging description</b> | Carton box  |
|   |   | <b>Sub-packaging quantity</b>    | 10 Pcs  |
|   |   | <b>Sub-packaging EAN barcode</b> | 8015747063845   |

Part number

# PE 1643 SA



Catalogue drawings

(16 / 32A) PE ... SA

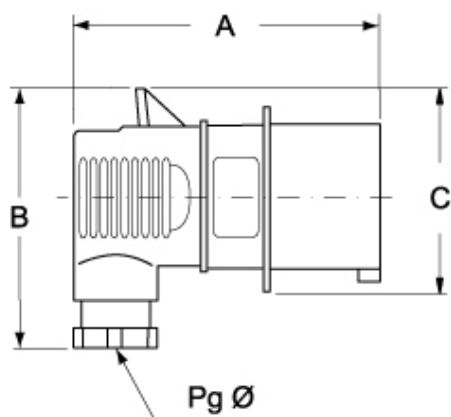

| PE...SA         | A   | B   | C  | Pg Ø |
|-----------------|-----|-----|----|------|
| <b>16A</b> 2P+⊕ | 100 | 77  | 59 | 13,5 |
| 3P+⊕            | 100 | 84  | 68 | 16   |
| 3P+N+⊕          | 106 | 91  | 77 | 16   |
| <b>32A</b> 2P+⊕ | 131 | 100 | 82 | 21   |
| 3P+⊕            | 131 | 100 | 82 | 21   |
| 3P+N+⊕          | 131 | 107 | 93 | 21   |