

Part number

# MZAPR 06 L32



Surface mounting housing, 180 °C series, with 1 lever, M32 cable entry, size "44.27", high construction

#### Product description

<b>Product type</b>	Surface mounting housing
<b>Series</b>	180 °C
<b>Closing type</b>	With 1 lever
<b>Size</b>	Size 44.27
<b>Cable entry</b>	With cable entry M32
<b>Specification</b>	High construction

#### Technical data

**IP degree of protection** IP65

#### Further technical details

<b>Weight</b>	294,00 g
<b>Operating temperature range (min, max)</b>	-40°C ... +180°C

#### Material properties

<b>RoHs conformity</b>	Compliant
<b>China RoHs - EFUP</b>	E
<b>REACH SVHC substances</b>	No
<b>Approvals / Standards</b>	
<b>Certifications</b>	DNV, BV
<b>UL</b>	ECBT2
<b>cUL</b>	ECBT8

#### General ordering information

<b>EAN13 code</b>	8015747154031
<b>eCl@ss 8.1</b>	27440202
<b>ETIM 7.0</b>	EC000437

#### Packaging Information

<b>Sub-packaging weight</b>	1,47 kg
<b>Sub-packaging description</b>	Plastic packaging
<b>Sub-packaging quantity</b>	5 Pcs
<b>Sub-packaging EAN barcode</b>	8015747255882

Part number

# MZAPR 06 L32



Catalogue drawings

## CZIR L

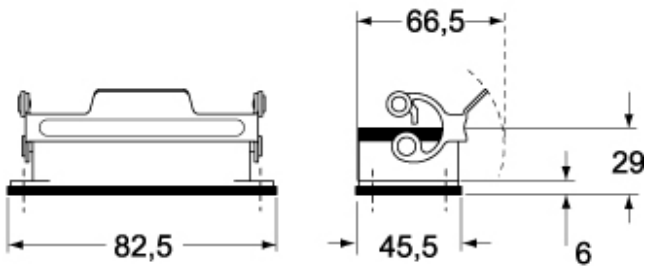

## CZPR L CZAPR L - MZPR L MZAPR L

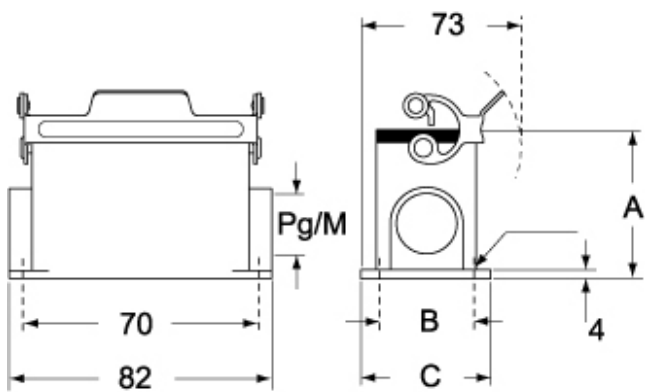

## CHCR L

