

Part number

MHP 10.220

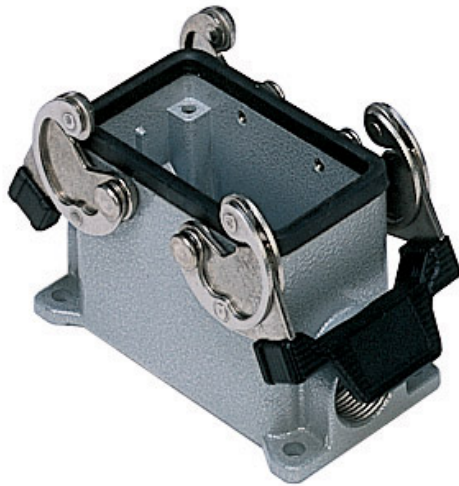

Surface mounting housing, C-TYPE series, with 2 levers, M20 x 2 cable entry, size "57.27"



| Product description | | Material properties | |
|---|-----------------------------|----------------------------------|---|
| Product type | Surface mounting housing | Other materials | Lever: Stainless steel, polyamide (PA) Gasket: NBR |
| Series | C-TYPE | Colour | RAL 7040 grey |
| Closing type | With 2 levers | RoHs conformity | Compliant |
| Size | Size 57.27 | China RoHs - EFUP | E |
| Cable entry | With cable entry M20 x 2 | REACH SVHC substances | No |
| Technical data | | Approvals / Standards | |
| IP degree of protection | IP65 / IP66 / IP69 | Certifications | DNV, BV |
| Further technical details | | UL | ECBT2 |
| Weight | 298,00 g | cUL | ECBT8 |
| Operating temperature range (min, max) | -40°C...+125°C | General ordering information | |
| | | EAN13 code | 8015747054362 |
| | | eCl@ss 8.1 | 27440202 |
| | | ETIM 7.0 | EC000437 |
| | | Packaging Information | |
| | | Packaging length | 475,00 mm |
| | | Packaging height | 170,00 mm |
| | | Packaging width | 150,00 mm |
| | | Packaging weight | 3,50 kg |
| | | Packaging volume | 12,11 dm ³ |
| | | Packaging description | Carton box |
| | | Packaging quantity | 10 Pcs |
| | | Packaging EAN code | 8015747252133 |
| | | Sub-packaging weight | 1,75 kg |
| | | Sub-packaging description | Plastic packaging |
| | | Sub-packaging quantity | 5 Pcs |
| | | Sub-packaging EAN barcode | 8015747054386 |

Part number

MHP 10.220



Catalogue drawings

CHP CAP - MHP MAP

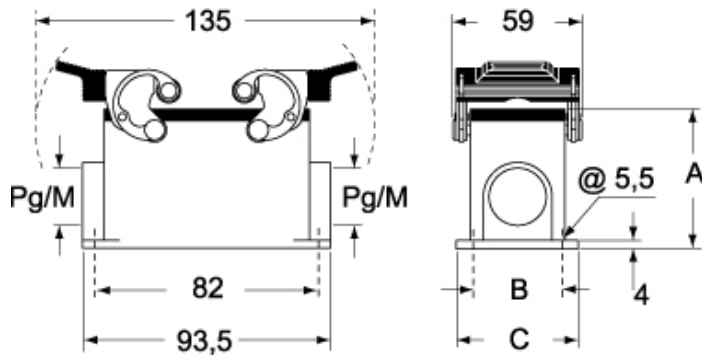

CHP CS/CP CAP CS/CP - MHP CS/CP MAP CS/CP



| | A | B | C |
|-----------------|----|----|----|
| CHP L / MHP L | 57 | 40 | 52 |
| CAP L / MAP L | 73 | 45 | 57 |
| CHP CS / MHP CS | 57 | 40 | 52 |
| CAP CS / MAP CS | 73 | 45 | 57 |
| CHP CP / MHP CP | 57 | 40 | 52 |
| CAP CP / MAP CP | 73 | 45 | 57 |