

Part number

FM 32 MT



Box system carrying handle, FM series



Product description

Product type Box system carrying handle
Series FM

Further technical details

Weight 45,00 g
Operating temperature range (min, max) -40°C ... +125°C

Material properties

Colour RAL 7035 grey

General ordering information

EAN13 code 8015747047463

Packaging Information

Sub-packaging weight 0,05 kg
Sub-packaging description Plastic packaging
Sub-packaging quantity 1 Pcs
Sub-packaging EAN barcode 8015747047470

Part number FM 32 MT



Catalogue drawings

FM complementary parts and accessories



Box system carrying handle
Climbing irons for box fixing



DIN-rail EN 60715 - Insulated terminal block
Collar - Screws kit - Adhesive label



Description

Part No.

Part No.

Box system carrying handle
- For 3236, 2451, 3251, 3221 and 4272 boards

FM 32 MT

Climbing irons for external wall mounting
- For 3236, 2451, 3251, 3221 and 4272 boards

BC SFT

Sized DIN-rail EN 60715 (35 mm)
With back plates for the positioning at different depths and fixing screws
- For 2451 boards
- For 3236, 3251, 3221 boards
- For 4272 boards

FM GD 18
FM GD 25
FM GD 35

Insulated terminal block, 3 P 25 mm² + 10 P 10 mm²
- For neutral and/or ground, compliant with EN 60998-2-1, stackable (up to 2 units)

FM 2510 MI

collar
- for format 1043 box system

FM 1043 CO

screws kit
- for mounting sockets PQ-PI-PQF-PIF series

FM 416

adhesive label
- for the identification of the mounted modular devices

FM 18 ET

Dimensions in mm

FM 32 MT

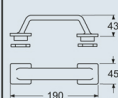

Dimensions in mm

FM GDxx

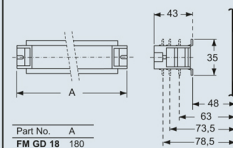

BC SFT

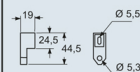

FM 2510 MI

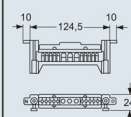

Dimensions indicated are not binding and may be changed without prior notice.