

Part number

# CGP 24.236



Surface mounting housing, IP68 series, for 2 screws, Pg36 x 2 cable entry, size "104.27"

#### Product description

<b>Product type</b>	Surface mounting housing
<b>Series</b>	IP68
<b>Closing type</b>	With 2 screws
<b>Size</b>	Size 104.27
<b>Cable entry</b>	With cable entry Pg36 x 2

#### Technical data

**IP degree of protection** IP66 / IP68 / IP69

#### Further technical details

<b>Weight</b>	1.086,00 g
<b>Operating temperature range (min, max)</b>	-40°C...+125°C

#### Material properties

<b>Main material</b>	Aluminium die-cast
<b>Other materials</b>	Gasket: NBR
<b>Colour</b>	RAL 9005 black
<b>RoHs conformity</b>	Compliant
<b>China RoHs - EFUP</b>	E
<b>REACH SVHC substances</b>	No

#### Approvals / Standards

<b>Certifications</b>	DNV, BV
<b>UL</b>	ECBT2
<b>cUL</b>	ECBT8

#### General ordering information

**EAN13 code** 8015747125109

#### Packaging Information

<b>Packaging length</b>	270,00 mm
<b>Packaging height</b>	130,00 mm
<b>Packaging width</b>	135,00 mm
<b>Packaging weight</b>	2,31 kg
<b>Packaging volume</b>	4,74 dm <sup>3</sup>
<b>Packaging description</b>	Carton box
<b>Packaging quantity</b>	2 Pcs
<b>Packaging EAN code</b>	8015747125116
<b>Sub-packaging weight</b>	1,16 kg
<b>Sub-packaging description</b>	Plastic packaging
<b>Sub-packaging quantity</b>	1 Pcs
<b>Sub-packaging EAN barcode</b>	8015747125123

Part number

# CGP 24.236



Catalogue drawings

## CGP - MGP

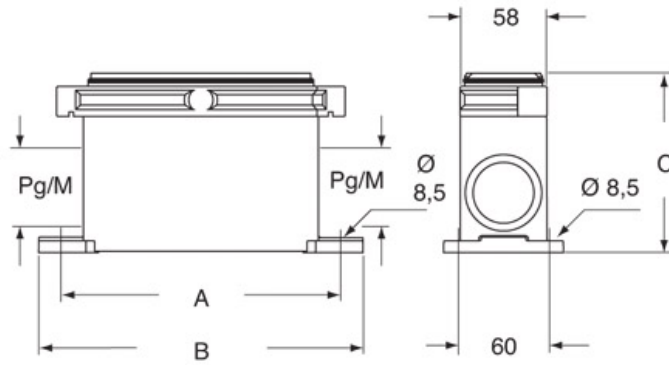

	<b>A</b>	<b>B</b>	<b>C</b>
<b>CGP 06 - MGP 06</b>	127	156	110
<b>CGP 10 - MGP 10</b>	140	169	110
<b>CGP 16 - MGP 16</b>	160	189	121
<b>CGP 24 - MGP 24</b>	187	216	121