

Part number

TM 3234KIR



Interlocked switched socket-outlet, TM series, 3 poles + PE, 3 h (red), 32 A, 380 ÷ 380 V, with compartment for modular units, 4,5 DIN-rail modules EN 60715, with base box

Product description		Material properties	
Product type	Interlocked switched socket-outlet	Colour	RAL 7012 grey, RAL 3000 red
Series	TM..IR/KIR		Compliant with exemption 6(c): copper alloy containing up to 4% lead by weight
N. of poles	3 poles + 	RoHs conformity	
Clock position	3	China RoHs - EFUP	50
Specification	With compartment for modular units, 4,5 DIN-rail modules EN 60715 With base box	REACH SVHC substances	Yes Lead
Technical data		SCIP number	Ce861c8d-b979-403b-96d9-80aef6dc281d
Current	32 A	Approvals / Standards	
Voltage	380V (50Hz.) 440V (60Hz.)	Reference standard	EN 60309-1, -2 e -4
IP degree of protection	IP66 / IP67	General ordering information	
Further technical details		EAN13 code	8015747162807
Weight	1.410,00 g	Packaging Information	
Operating temperature range (min, max)	-25°C ... +40°C	Packaging length	385,00 mm
UL 94 flammability rating	V-2	Packaging height	320,00 mm
IK rating (impact degree of protection)	IK10	Packaging width	485,00 mm
		Packaging weight	12,69 kg
		Packaging volume	59,75 dm ³
		Packaging description	Carton box
		Packaging quantity	9 Pcs
		Packaging EAN code	8015747166300
		Sub-packaging weight	1,41 kg
		Sub-packaging description	Carton tray
		Sub-packaging quantity	1 Pcs
		Sub-packaging EAN barcode	8015747166317

Part number

TM 3234KIR



Catalogue drawings

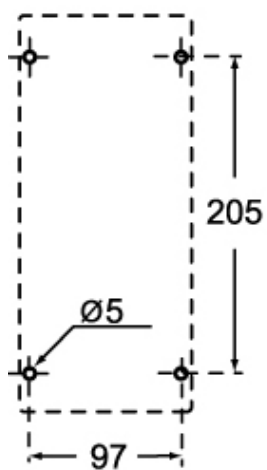

	A	B
2P+\oplus	133	276
3P+\oplus	135	276
3P+N+\oplus	140	277