

Part number

PEW 6395 PQ



Flush-mounting socket outlet, PLUSO series, 3 poles + N + PE, 9 h (blue), 63 A, 120/208 ÷ 144/250 V, straight

Product description

Product type	Socket Flush-mounting
Series	PEW...PQ, PLUSO
N. of poles	3 poles + N + 
Clock position	9
Specification	Straight

Technical data

Current	63 A
Voltage	120/208 ÷ 144/250 V
IP degree of protection	IP67

Further technical details

Weight	729,00 g
Operating temperature range (min, max)	-25°C ... +40°C

Material properties

Colour	RAL 7035 grey, RAL 5015 blue
RoHs conformity	Compliant with exemption 6(c): copper alloy containing up to 4% lead by weight
China RoHs - EFUP	50
REACH SVHC substances	Yes Lead
SCIP number	Ca7de37f-add8-4b77-9861-279c94903ade

Approvals / Standards

Reference standard	EN 60309-1 and -2
---------------------------	-------------------

General ordering information

EAN13 code	8015747078382
-------------------	---------------

Packaging Information

Packaging length	290,00 mm
Packaging height	140,00 mm
Packaging width	215,00 mm
Packaging weight	3,20 kg
Packaging volume	8,73 dm ³
Packaging description	Carton box
Packaging quantity	4 Pcs
Packaging EAN code	8015747078399

Part number

PEW 6395 PQ



Catalogue drawings

(63 / 125A) PEW ... PQ

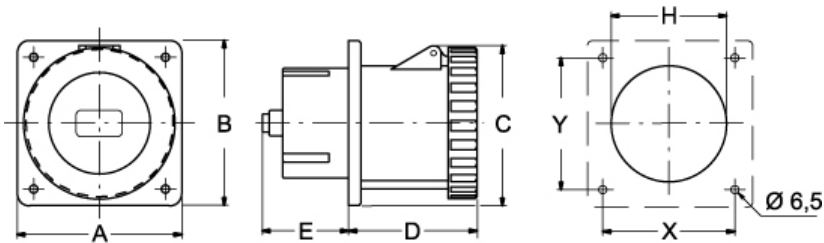

PEW ... PQ	A	B	C	D	E	H	X	Y
63A 2P+⊕	100	107	109	92	30	73	77	85
3P+⊕	100	107	109	92	30	73	77	85
3P+N+⊕	100	107	109	92	30	73	77	85
125A 2P+⊕	130	130	130	101	68	91	104	104
3P+⊕	130	130	130	101	68	91	104	104
3P+N+⊕	130	130	130	101	68	91	104	104