

Part number

PEW 12565 PQ



Flush-mounting socket outlet, PLUSO series, 3 poles + N + PE, 6 h (red), 125 A, 380 ÷ 415 V, straight

Product description		Material properties	
Product type	Socket Flush-mounting	Colour	RAL 7035 grey, RAL 3000 red
Series	PEW...PQ, PLUSO	RoHs conformity	Compliant with exemption 6(c): copper alloy containing up to 4% lead by weight
Connection type	Screw terminal connection	China RoHs - EFUP	50
N. of poles	3 poles + N + 	REACH SVHC substances	Yes Lead
Clock position	6	SCIP number	Ca7de37f-add8-4b77-9861-279c94903ade
Specification	Straight	Approvals / Standards	
Technical data		Reference standard	EN 60309-1 and -2
Current	125 A	General ordering information	
Voltage	380 ÷ 415 V	EAN13 code	8015747070560
IP degree of protection	IP67	Packaging Information	
Further technical details		Packaging length	335,00 mm
Weight	1.700,00 g	Packaging height	320,00 mm
Operating temperature range (min, max)	-25°C ... +40°C	Packaging width	400,00 mm
		Packaging weight	14,70 kg
		Packaging volume	42,88 dm ³
		Packaging description	Carton box
		Packaging quantity	8 Pcs
		Packaging EAN code	8015747070577
		Sub-packaging weight	1,84 kg
		Sub-packaging description	Carton box
		Sub-packaging quantity	1 Pcs
		Sub-packaging EAN barcode	8015747070584

Part number

PEW 12565 PQ



Catalogue drawings

(63 / 125A) PEW ... PQ

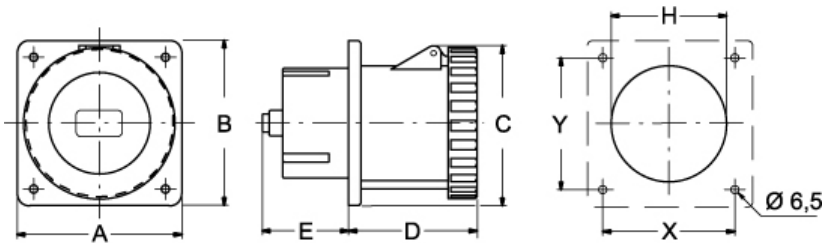

PEW ... PQ	A	B	C	D	E	H	X	Y
63A 2P+⊕	100	107	109	92	30	73	77	85
3P+⊕	100	107	109	92	30	73	77	85
3P+N+⊕	100	107	109	92	30	73	77	85
125A 2P+⊕	130	130	130	101	68	91	104	104
3P+⊕	130	130	130	101	68	91	104	104
3P+N+⊕	130	130	130	101	68	91	104	104