

Part number

# PE 1675 PQ



Flush-mounting socket outlet, PLUSO series, 3 poles + N + PE, 7 h (black), 16 A, 277/480 ÷ 288/500 V, straight

#### Product description

<b>Product type</b>	Socket Flush-mounting
<b>Series</b>	PE...PQ, PLUSO
<b>N. of poles</b>	3 poles + N + 
<b>Clock position</b>	7
<b>Specification</b>	Straight

#### Technical data

<b>Current</b>	16 A
<b>Voltage</b>	277/480 ÷ 288/500 V
<b>IP degree of protection</b>	IP44

#### Further technical details

<b>Weight</b>	161,00 g
<b>Operating temperature range (min, max)</b>	-25°C ... +40°C

#### Material properties

<b>Colour</b>	RAL 7035 grey, RAL 9005 black
<b>RoHs conformity</b>	Compliant with exemption 6(c): copper alloy containing up to 4% lead by weight
<b>China RoHs - EFUP</b>	50
<b>REACH SVHC substances</b>	Yes Lead
<b>SCIP number</b>	Ca7de37f-add8-4b77-9861-279c94903ade

#### Approvals / Standards

<b>Reference standard</b>	EN 60309-1 and -2
---------------------------	-------------------

#### General ordering information

<b>EAN13 code</b>	8015747065139
-------------------	---------------

#### Packaging Information

<b>Packaging length</b>	285,00 mm
<b>Packaging height</b>	170,00 mm
<b>Packaging width</b>	190,00 mm
<b>Packaging weight</b>	1,94 kg
<b>Packaging volume</b>	9,21 dm <sup>3</sup>
<b>Packaging description</b>	Carton box
<b>Packaging quantity</b>	10 Pcs
<b>Packaging EAN code</b>	8015747065146

Part number

# PE 1675 PQ



Catalogue drawings

(16 / 32A) PE ... PQ

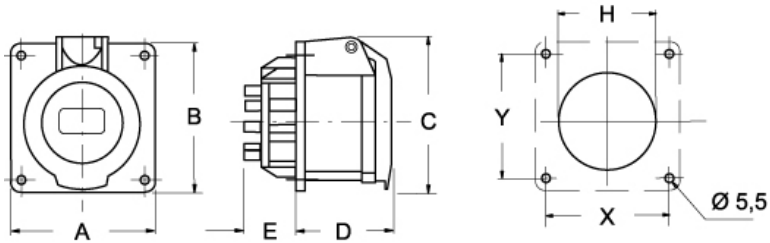

PE ... PQ	A	B	C	D	E	H	X	Y
<b>16A</b> 2P+⊖	65	65	71	52	27	60	52	52
3P+⊖	65	65	75	53	27	61,5	52	52
3P+N+⊖	80	80	86	53	27	70	60	60
<b>32A</b> 2P+⊖	80	80	87	62	28	68	60	60
3P+⊖	80	80	87	62	28	68	60	60
3P+N+⊖	80	80	92	62	28	73	60	60