

Part number

C7AP 10.21



Surface mounting housing, V-TYPE series, with 2 levers, Pg21 cable entry, size "57.27", high construction

Product description

Product type	Surface mounting housing
Series	V-TYPE
Closing type	With 2 levers
Size	Size 57.27
Cable entry	With cable entry Pg21
Specification	High construction

Technical data

IP degree of protection	IP66 / IP67 / IP69
--------------------------------	--------------------

Further technical details

Weight	380,00 g
Operating temperature range (min, max)	-40°C...+125°C

Material properties

Other materials	Lever: Stainless steel Gasket: NBR
Colour	RAL 7040 grey
RoHs conformity	Compliant
China RoHs - EFUP	E
REACH SVHC substances	No

Approvals / Standards

Certifications	DNV, BV
UL	ECBT2
cUL	ECBT8

General ordering information

EAN13 code	8015747060271
-------------------	---------------

Packaging Information

Packaging length	250,00 mm
Packaging height	145,00 mm
Packaging width	300,00 mm
Packaging weight	4,00 kg
Packaging volume	10,88 dm ³
Packaging description	Carton box
Packaging quantity	10 Pcs
Packaging EAN code	8015747248822
Sub-packaging weight	2,00 kg
Sub-packaging description	Plastic packaging
Sub-packaging quantity	5 Pcs
Sub-packaging EAN barcode	8015747115230

Part number

C7AP 10.21



Catalogue drawings

C7P - C7AP M7P - M7AP

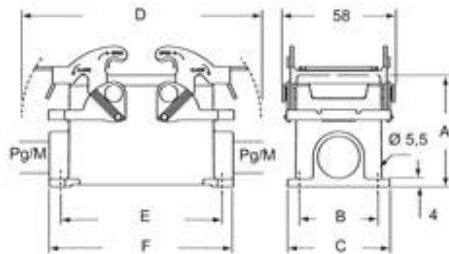

	A	B	C	D	E	F
C7P/M7P 10	57	40	52	122	82	93,5
C7P/M7P 16	63	45	57	142,5	105	117
C7P/M7P 24	63	45	57	169	132	144
C7AP/M7AP 10	73	45	57	122	82	93,5
C7AP/M7AP 16	77	45	57	142,5	105	117
C7AP/M7AP 24	80	45	57	169	132	144