

Part number

TM 1644 IR



Interlocked switched socket-outlet, TM series, 3 poles + PE, 4 h (yellow), 16 A, 100 ÷ 130 V, with compartment for modular units, 4,5 DIN-rail modules EN 60715, with base box

Product description		Material properties	
Product type	Interlocked switched socket-outlet	Colour	RAL 7012 grey, RAL 1021 yellow
Series	TM..IR/KIR		Compliant with exemption 6(c): copper alloy containing up to 4% lead by weight
N. of poles	3 poles +	RoHs conformity	6(c): copper alloy containing up to 4% lead by weight
Clock position	4	China RoHs - EFUP	50
Size	115 x 450 x 18 mm	REACH SVHC substances	Yes Lead
Specification	With compartment for modular units, 4,5 DIN-rail modules EN 60715 With base box	SCIP number	Ce861c8d-b979-403b-96d9-80aef6dc281d
Technical data		Approvals / Standards	
Current	16 A	Reference standard	EN 60309-1, -2 e -4
Voltage	100 ÷ 130 V	General ordering information	
IP degree of protection	IP66 / IP67	EAN13 code	8015747089630
Further technical details		Packaging Information	
Weight	1.350,00 g	Packaging weight	12,75 kg
Operating temperature range (min, max)	-25°C ... +40°C	Packaging volume	52,36 dm ³
UL 94 flammability rating	V-2	Packaging description	Carton box
IK rating (impact degree of protection)	IK10	Packaging quantity	9 Pcs
		Packaging EAN code	8015747204347
		Sub-packaging weight	1,42 kg
		Sub-packaging description	Plastic packaging
		Sub-packaging quantity	1 Pcs
		Sub-packaging EAN barcode	8015747106962

Part number

TM 1644 IR



Catalogue drawings

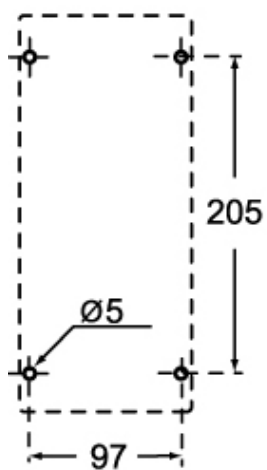

	A	B
2P+⊕	133	276
3P+⊕	135	276
3P+N+⊕	140	277