

Part number

TM 1625 IS



Interlocked switched socket-outlet, TM series, 3 poles + N + PE, 2 h (green), 16 A, > 50 V, sectionable fuse carrier 10 x 38 mm, with base box

Product description	
Product type	Interlocked switched socket-outlet
Series	TM.. IS/KIS
N. of poles	3 poles + N + 
Clock position	2
Specification	Sectionable fuse carrier 10 x 38 mm With base box
Technical data	
Current	16 A
Voltage	> 50 V
IP degree of protection	IP66 / IP67
Further technical details	
Operating temperature range (min, max)	-25°C ... +40°C
UL 94 flammability rating	V-2
IK rating (impact degree of protection)	IK10

Material properties	
Colour	RAL 7012 grey, RAL 6017 green
Approvals / Standards	
Reference standard	EN 60309-1, -2 e -4
General ordering information	
EAN13 code	8015747161107

Part number

TM 1625 IS



Catalogue drawings

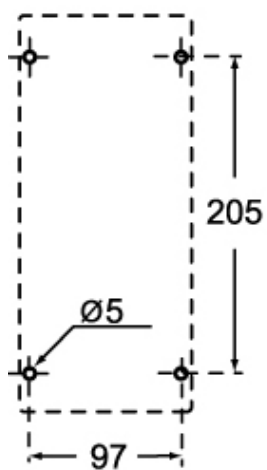

	A	B
2P+ \oplus	133	276
3P+ \oplus	135	276
3P+N+ \oplus	140	277