

Part number

PEW 6333 PQ



Flush-mounting socket outlet, PLUSO series, 2 poles + PE, 3 h (white), 63 A, 50 ÷ 250 V, straight

Product description

Product type	Socket Flush-mounting
Series	PEW...PQ, PLUSO
N. of poles	2 poles + 
Clock position	3
Specification	Straight

Technical data

Current	63 A
Voltage	> 50 ÷ 250 V
IP degree of protection	IP67

Further technical details

Operating temperature range (min, max)	-25°C ... +40°C
---	-----------------

Material properties

Colour	RAL 7035 grey, RAL 9010 white
---------------	-------------------------------

Approvals / Standards

Reference standard	EN 60309-1 and -2
---------------------------	-------------------

General ordering information

EAN13 code	8015747158282
-------------------	---------------

Part number

PEW 6333 PQ



Catalogue drawings

(63 / 125A) PEW ... PQ

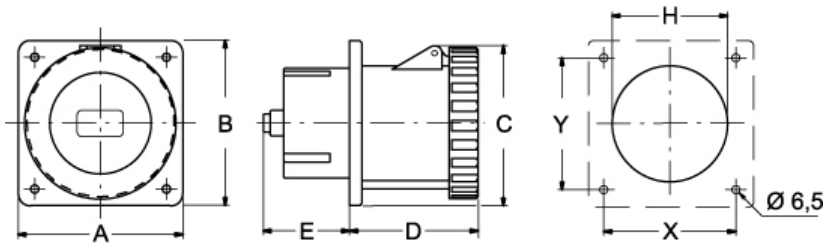

PEW ... PQ	A	B	C	D	E	H	X	Y
63A 2P+⊕	100	107	109	92	30	73	77	85
3P+⊕	100	107	109	92	30	73	77	85
3P+N+⊕	100	107	109	92	30	73	77	85
125A 2P+⊕	130	130	130	101	68	91	104	104
3P+⊕	130	130	130	101	68	91	104	104
3P+N+⊕	130	130	130	101	68	91	104	104