

Part number

PE 1634 SM



Wall-mounting plug, PLUSO series, 3 poles + PE, 3 h (red), 16 A, 380 ÷ 380 V

Product description

Product type	Plug Wall-mounting
Series	PE...SM, PLUSO
N. of poles	3 poles + 
Clock position	3

Technical data

Current	16 A
Voltage	380V (50Hz.) 440V (60Hz.)
IP degree of protection	IP44

Further technical details

Operating temperature range (min, max)	-25°C ... +40°C
---	-----------------

Material properties

Colour	RAL 7035 grey, RAL 3000 red
---------------	-----------------------------

Approvals / Standards

Reference standard	EN 60309-1 and -2
---------------------------	-------------------

General ordering information

EAN13 code	8015747154840
-------------------	---------------

Part number

PE 1634 SM



Catalogue drawings

(16 / 32A) PE ... SM

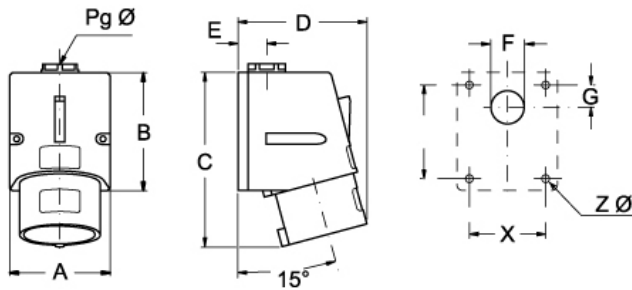

PE ... SM	A	B	C	D	E	F	G	X	Y	Z Ø	Pg Ø
16A 2P+⊕	70	82	115	75	20	23	16	53	65	4,5	16
3P+⊕	70	82	117	75	20	23	16	53	65	4,5	16
3P+N+⊕	70	82	121	90	20	23	16	53	65	4,5	16
32A 2P+⊕	86	104	145	95	24	29	17	61	79	6,5	21
3P+⊕	86	104	145	95	24	29	17	61	79	6,5	21
3P+N+⊕	86	104	147	95	24	29	17	61	79	6,5	21