

Part number

PE 1623 SM



Wall-mounting plug, PLUSO series, 2 poles + PE, 2 h (green), 16 A, > 50 V

Product description

Product type	Plug Wall-mounting
Series	PE...SM, PLUSO
N. of poles	2 poles + 
Clock position	2

Technical data

Current	16 A
Voltage	> 50 V
IP degree of protection	IP44

Further technical details

Operating temperature range (min, max)	-25°C ... +40°C
---	-----------------

Material properties

Colour	RAL 7035 grey, RAL 6017 green
---------------	-------------------------------

Approvals / Standards

Reference standard	EN 60309-1 and -2
---------------------------	-------------------

General ordering information

EAN13 code	8015747154659
-------------------	---------------

Part number

PE 1623 SM



Catalogue drawings

(16 / 32A) PE ... SM

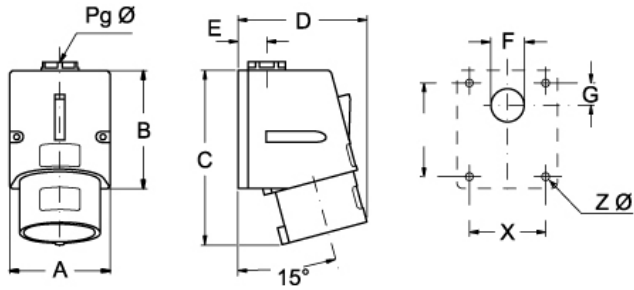

PE ... SM	A	B	C	D	E	F	G	X	Y	Z Ø	Pg Ø	
16A	2P+⊕	70	82	115	75	20	23	16	53	65	4,5	16
	3P+⊕	70	82	117	75	20	23	16	53	65	4,5	16
	3P+N+⊕	70	82	121	90	20	23	16	53	65	4,5	16
32A	2P+⊕	86	104	145	95	24	29	17	61	79	6,5	21
	3P+⊕	86	104	145	95	24	29	17	61	79	6,5	21
	3P+N+⊕	86	104	147	95	24	29	17	61	79	6,5	21