

Part number

CAV 24 LG29



Hood, C-TYPE series, with 1 lever, Pg29 top cable entry, size "104.27", high construction

Product description	
Product type	Hood
Series	C-TYPE
Closing type	With 1 lever
Size	Size 104.27
Cable entry	Top cable entry with adapter Pg29
Specification	High construction
Technical data	
IP degree of protection	IP65 / IP66 / IP69
Further technical details	
Weight	395,00 g
Operating temperature range (min, max)	-40°C...+125°C

Material properties	
Other materials	Lever: Stainless steel, polyamide (PA) Gasket: NBR
Colour	RAL 7040 grey
RoHs conformity	Compliant with exemption 6(c): copper alloy containing up to 4% lead by weight
China RoHs - EFUP	50
REACH SVHC substances	Yes Lead
SCIP number	15deaf78-e939-4401-a0b0-e2228ca32a03
Approvals / Standards	
Certifications	DNV, BV
UL	ECBT2
cUL	ECBT8
General ordering information	
EAN13 code	8015747010030
Packaging Information	
Packaging length	250,00 mm
Packaging height	145,00 mm
Packaging width	300,00 mm
Packaging weight	4,00 kg
Packaging volume	10,88 dm ³
Packaging description	Carton box
Packaging quantity	10 Pcs
Packaging EAN code	8015747226196
Sub-packaging weight	2,00 kg
Sub-packaging description	Plastic packaging
Sub-packaging quantity	5 Pcs
Sub-packaging EAN barcode	8015747010047

Part number

CAV 24 LG29



Catalogue drawings

CHO L (CAO L) - MHO L [MAO L]

CHV L [CAV L] - MHV L (MAV L)

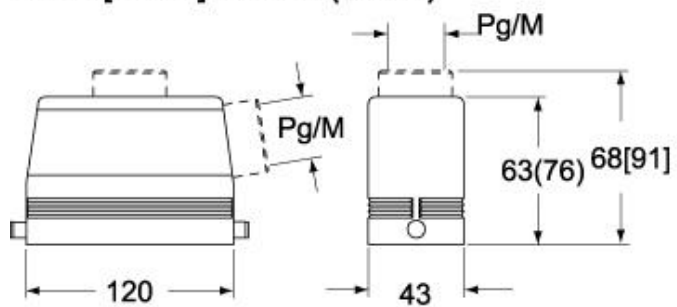

CHV LG (CAV LG), MHV LG (MAV LG) [MFV LG]

