

Part number

# TM 63114 IS



Interlocked switched socket-outlet, TM series, 3 poles + PE, 11 h (red), 63 A, 440 ÷ 460 V, sectionable fuse carrier 22 x 58 mm, with base box

#### Product description

<b>Product type</b>	Interlocked switched socket-outlet
<b>Series</b>	TM.. IS/KIS
<b>N. of poles</b>	3 poles + 
<b>Clock position</b>	11
<b>Specification</b>	Sectionable fuse carrier 22 x 58 mm With base box

#### Technical data

<b>Current</b>	63 A
<b>Voltage</b>	440 ÷ 460 V
<b>IP degree of protection</b>	IP66 / IP67

#### Further technical details

<b>Operating temperature range (min, max)</b>	-25°C ... +40°C
<b>UL 94 flammability rating</b>	V-0 (insert), V-2 (enclosure)
<b>IK rating (impact degree of protection)</b>	IK10

#### Material properties

<b>Colour</b>	RAL 7012 grey, RAL 3000 red
---------------	-----------------------------

#### Approvals / Standards

<b>Reference standard</b>	EN 60309-1, -2 e -4
---------------------------	---------------------

#### General ordering information

<b>EAN13 code</b>	8015747163422
-------------------	---------------

Part number

# TM 63114 IS



Catalogue drawings

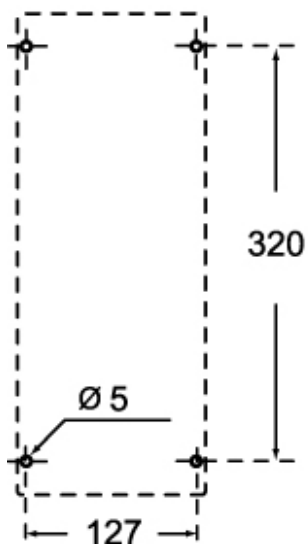

Notes