

Part number  
**SQ 1663**



Interlocked switched socket-outlet, SQ series,  
 2 poles + PE, 6 h (blue), 16 A, 200 ÷ 250 V,  
 without fuse-carrier

Product description	
<b>Product type</b>	Interlocked switched socket-outlet
<b>Series</b>	SQ
<b>N. of poles</b>	2 poles + 
<b>Clock position</b>	6
<b>Size</b>	Socket centre distance 115 x 144 mm
<b>Specification</b>	Without fuse-carrier
Technical data	
<b>Current</b>	16 A
<b>Voltage</b>	200 ÷ 250 V
<b>IP degree of protection</b>	IP44
Further technical details	
<b>Weight</b>	367,00 g
<b>Operating temperature range (min, max)</b>	-25°C ... +40°C
<b>IK rating (impact degree of protection)</b>	IK08

Material properties	
<b>Colour</b>	RAL 7035 grey, RAL 5015 blue
<b>RoHs conformity</b>	Compliant with exemption 6(c): copper alloy containing up to 4% lead by weight
<b>China RoHs - EFUP</b>	50
<b>REACH SVHC substances</b>	Yes Lead
<b>SCIP number</b>	Ce861c8d-b979-403b-96d9-80aef6dc281d
Approvals / Standards	
<b>Reference standard</b>	EN 60309-1, -2 e -4
General ordering information	
<b>EAN13 code</b>	8015747084215
Packaging Information	
<b>Packaging length</b>	225,00 mm
<b>Packaging height</b>	180,00 mm
<b>Packaging width</b>	435,00 mm
<b>Packaging weight</b>	3,92 kg
<b>Packaging volume</b>	17,62 dm <sup>3</sup>
<b>Packaging description</b>	Carton box
<b>Packaging quantity</b>	10 Pcs
<b>Packaging EAN code</b>	8015747084222
<b>Sub-packaging weight</b>	0,39 kg
<b>Sub-packaging description</b>	Plastic packaging
<b>Sub-packaging quantity</b>	1 Pcs
<b>Sub-packaging EAN barcode</b>	8015747084239

Part number

# SQ 1663



## Catalogue drawings

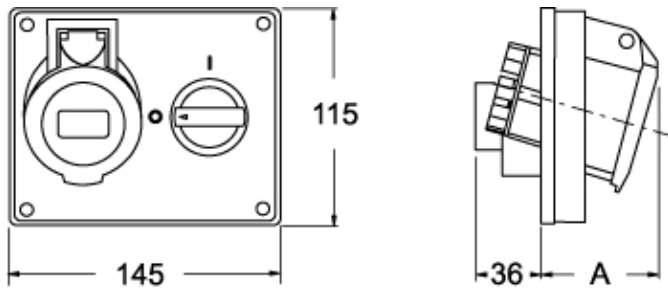

SQ		A
16A	2P+⊕	59
	3P+⊕	63
	3P+N+⊕	63

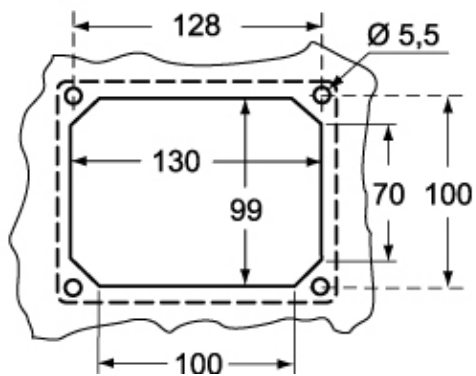

Notes