

Part number

RDM2D 0.3

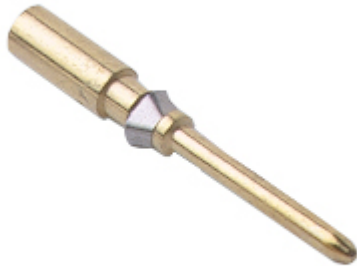

Male crimp contact, RD series, 10 A, turned gold plated, wire cross section 0,14 - 0,37 mm², AWG 26 - 22, HNM - High Number of Matings version

Product description		Material properties	
Product type	Crimp contact	RoHs conformity	Compliant with exemption 6(c): copper alloy containing up to 4% lead by weight
Series	RD	China RoHs - EFUP	50
Gender	Male	REACH SVHC substances	Yes Lead
Specification	HNM - High Number of Matings version	SCIP number	C0979fba-9907-458f-a94a-db781440f273
Technical data		Approvals / Standards	
Current	10 A	UL	ECBT2
Wire cross-section	0,14 mm ² - 0,37 mm ²	General ordering information	
AWG size	26 - 22	EAN13 code	8015747255516
Contact type	Turned gold plated	eCl@ss 8.1	27440204
Further technical details		ETIM 7.0	EC000796
Weight	0,88 g	Packaging Information	
Conductors stripping length	8 mm	Packaging length	112,00 mm
		Packaging height	95,00 mm
		Packaging width	117,00 mm
		Packaging weight	0,80 kg
		Packaging volume	1,24 dm ³
		Packaging description	Carton box
		Packaging quantity	800 Pcs
		Packaging EAN code	8015747257916
		Sub-packaging length	50,00 mm
		Sub-packaging height	44,00 mm
		Sub-packaging width	50,00 mm
		Sub-packaging weight	0,10 kg
		Sub-packaging volume	0,11 dm ³
		Sub-packaging description	Plastic box
		Sub-packaging quantity	100 Pcs
		Sub-packaging EAN barcode	8015747257923

Part number

RDM2D 0.3



Catalogue drawings

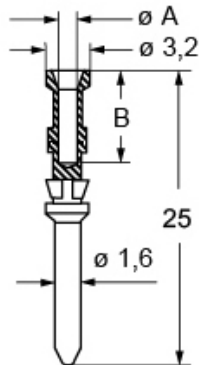

RDF2D and RDM2D contacts

conductor cross-sectional area mm ²	conductor slot $\varnothing A$ (mm)	conductor stripping length B (mm)
0,14-0,37	0,9	8
0,5	1,1	8
0,75	1,3	8
1,0	1,45	8
1,5	1,8	8
2,5	2,2	6

Notes

California Proposition 65 Information



WARNING

This product can expose you to lead and its compounds, known to the State of California to cause cancer and/or reproductive toxicity. For more information go to www.P65Warnings.ca.gov.