

Part number

PK 6363 EB



Interlocked switched socket-outlet, PK series,
2 poles + PE, 6 h (blue), 63 A, 200 ÷ 250 V,
without fuse-carrier

Product description		Material properties	
Product type	Interlocked switched socket-outlet	Colour	RAL 7035 grey, RAL 5015 blue
Series	PK..EB		Compliant with exemption 6(c): copper alloy containing up to 4% lead by weight
N. of poles	2 poles + 	RoHs conformity	60
Clock position	6	China RoHs - EFUP	50
Size	114x228 fixing plates FC xx41 TB	REACH SVHC substances	Yes Lead
Cable entry	Pg29	SCIP number	F6799547-ab84-42f2-938f-233ba663766d
Specification	Without fuse-carrier	Approvals / Standards	
Technical data		Reference standard	EN 60309-1, -2 e -4
Current	63 A	General ordering information	
Voltage	200 ÷ 250 V	EAN13 code	8015747082402
IP degree of protection	IP44	Packaging Information	
Further technical details		Packaging length	535,00 mm
Weight	1.704,00 g	Packaging height	320,00 mm
Operating temperature range (min, max)	-25°C ... +40°C	Packaging width	325,00 mm
IK rating (impact degree of protection)	IK10	Packaging weight	15,10 kg
		Packaging volume	55,64 dm ³
		Packaging description	Carton box
		Packaging quantity	8 Pcs
		Packaging EAN code	8015747082419
		Sub-packaging length	290,00 mm
		Sub-packaging height	125,00 mm
		Sub-packaging width	155,00 mm
		Sub-packaging weight	1,89 kg
		Sub-packaging volume	5,62 dm ³
		Sub-packaging description	Carton box
		Sub-packaging quantity	1 Pcs
		Sub-packaging EAN barcode	8015747082426

Part number

PK 6363 EB



Catalogue drawings

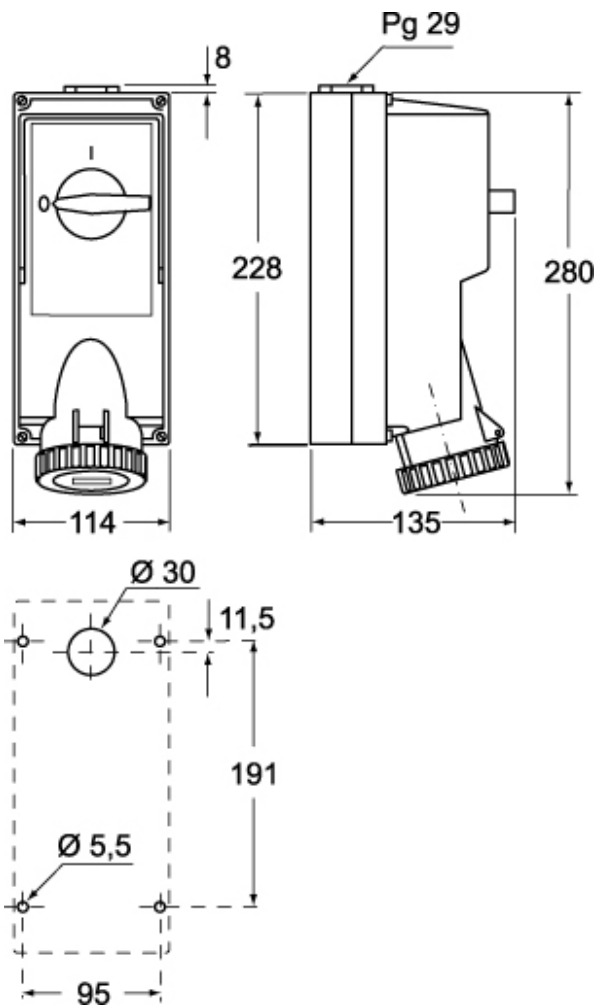

Notes