

Part number

PK 1695 EB



Interlocked switched socket-outlet, PK series,
3 poles + N + PE, 9 h (blue), 16 A, 120/208 ÷
144/250 V, without fuse-carrier

Product description	
Product type	Interlocked switched socket-outlet
Series	PK..EB
N. of poles	3 poles + N + 
Clock position	9
Size	114x228 fixing plates FC xx41 TB
Cable entry	Pg16
Specification	Without fuse-carrier
Technical data	
Current	16 A
Voltage	120/208 ÷ 144/250 V
IP degree of protection	IP44
Further technical details	
Weight	580,00 g
Operating temperature range (min, max)	-25°C ... +40°C
IK rating (impact degree of protection)	IK10

Material properties	
Colour	RAL 7035 grey, RAL 5015 blue
RoHs conformity	Compliant with exemption 6(c): copper alloy containing up to 4% lead by weight
China RoHs - EFUP	50
REACH SVHC substances	Yes Lead
SCIP number	Ce861c8d-b979-403b-96d9-80aef6dc281d
Approvals / Standards	
Reference standard	EN 60309-1, -2 e -4
General ordering information	
EAN13 code	8015747080781
Packaging Information	
Sub-packaging weight	0,58 kg
Sub-packaging description	Carton box
Sub-packaging quantity	1 Pcs
Sub-packaging EAN barcode	8015747080798

Part number

PK 1695 EB



Catalogue drawings

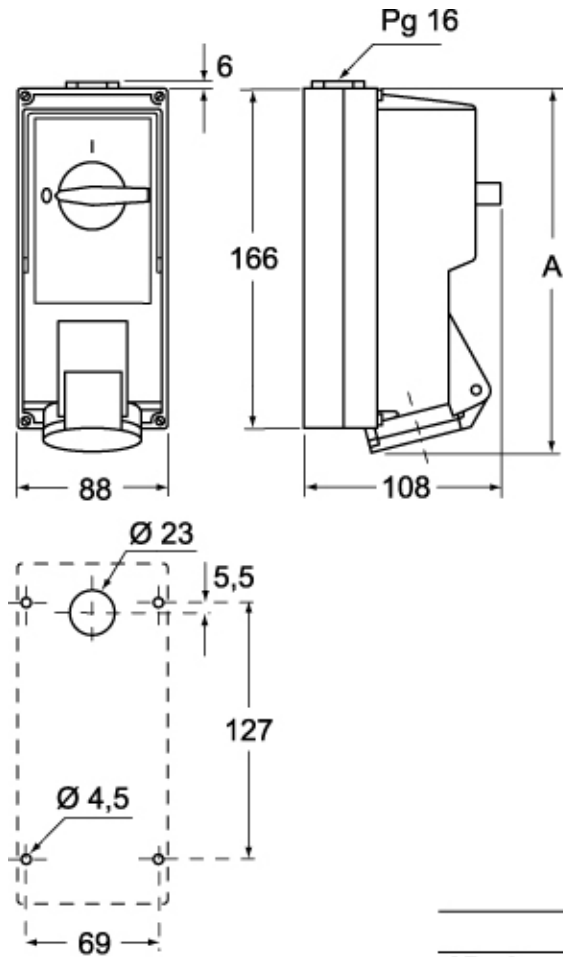

	A
2P+⊕	182
3P+⊕	182
3P+N+⊕	187

Notes