

Part number

# PK 1625 EB



Interlocked switched socket-outlet, PK series,  
3 poles + N + PE, 2 h (green), 16 A, > 50 V,  
without fuse-carrier

#### Product description

<b>Product type</b>	Interlocked switched socket-outlet
<b>Series</b>	PK..EB
<b>N. of poles</b>	3 poles + N + 
<b>Clock position</b>	2
<b>Specification</b>	Without fuse-carrier

#### Technical data

<b>Current</b>	16 A
<b>Voltage</b>	> 50 V
<b>IP degree of protection</b>	IP44

#### Further technical details

<b>Operating temperature range (min, max)</b>	-25°C ... +40°C
<b>IK rating (impact degree of protection)</b>	IK10

#### Material properties

<b>Colour</b>	RAL 7035 grey, RAL 6017 green
---------------	-------------------------------

#### Approvals / Standards

<b>Reference standard</b>	EN 60309-1, -2 e -4
---------------------------	---------------------

#### General ordering information

<b>EAN13 code</b>	8015747158770
-------------------	---------------

Part number

# PK 1625 EB



Catalogue drawings

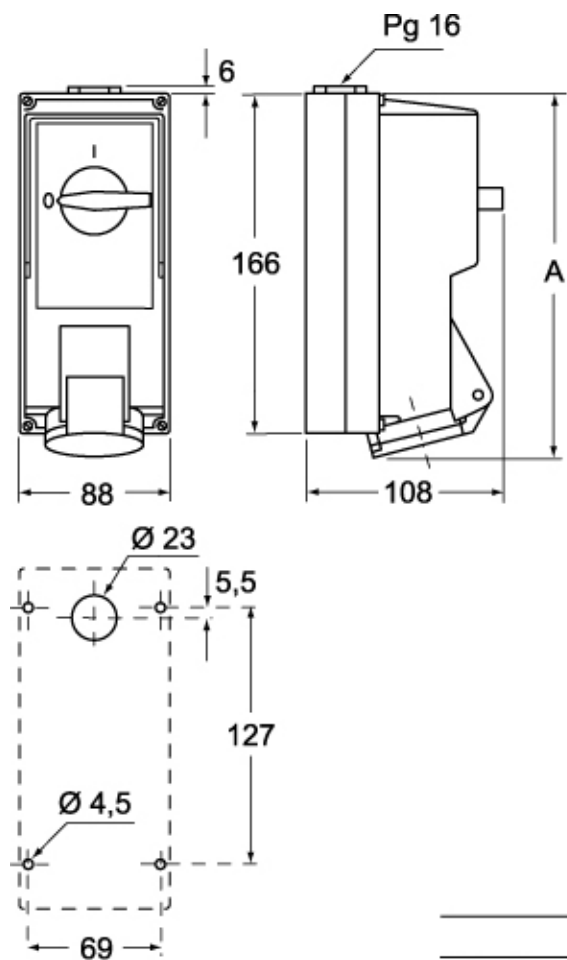

	<b>A</b>
<b>2P+⊕</b>	182
<b>3P+⊕</b>	182
<b>3P+N+⊕</b>	187

Notes