

Part number

PEW 6395 SI



Flush-mounting plug, PLUSO series, 3 poles + N + PE, 9 h (blue), 63 A, 120/208 ÷ 144/250 V

Product description

Product type	Plug Flush-mounting
Series	PEW...SI, PLUSO
N. of poles	3 poles + N + 
Clock position	9

Technical data

Current	63 A
Voltage	120/208 ÷ 144/250 V
IP degree of protection	IP67

Further technical details

Weight	741,00 g
Operating temperature range (min, max)	-25°C ... +40°C

Material properties

Colour	RAL 7035 grey, RAL 5015 blue
RoHs conformity	Compliant with exemption 6(c): copper alloy containing up to 4% lead by weight
China RoHs - EFUP	50
REACH SVHC substances	Yes Lead
SCIP number	Ca7de37f-add8-4b77-9861-279c94903ade

Approvals / Standards

Reference standard	EN 60309-1 and -2
---------------------------	-------------------

General ordering information

EAN13 code	8015747078429
-------------------	---------------

Packaging Information

Packaging length	255,00 mm
Packaging height	195,00 mm
Packaging width	245,00 mm
Packaging weight	3,23 kg
Packaging volume	12,18 dm ³
Packaging description	Carton box
Packaging quantity	4 Pcs
Packaging EAN code	8015747078436

Part number

PEW 6395 SI



Catalogue drawings

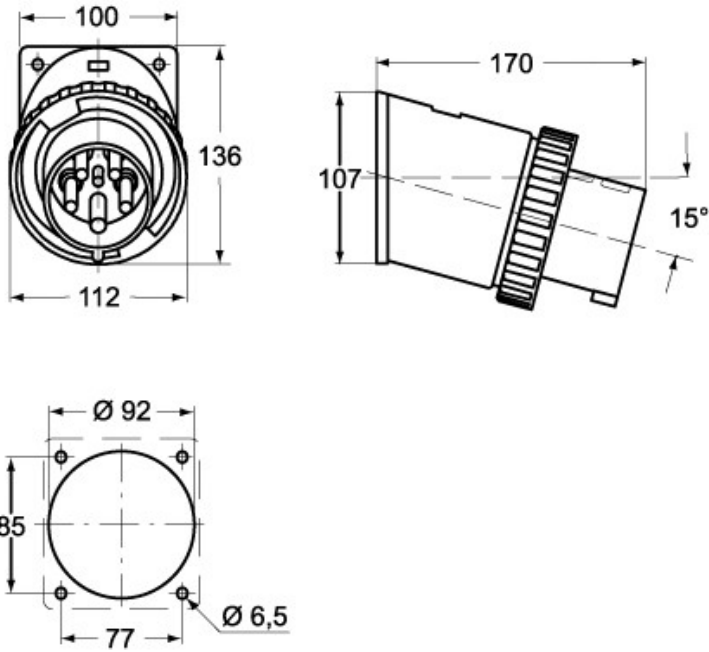

Notes