

Part number

# PEW 63115 PQ



Flush-mounting socket outlet, PLUSO series, 3 poles + N + PE, 11 h (red), 63 A, 250/440 ÷ 265/460 V, straight

## Product description

<b>Product type</b>	Socket Flush-mounting
<b>Series</b>	PEW...PQ, PLUSO
<b>N. of poles</b>	3 poles + N + 
<b>Clock position</b>	11
<b>Specification</b>	Straight

## Technical data

<b>Current</b>	63 A
<b>Voltage</b>	250/440V ÷ 265/460V
<b>IP degree of protection</b>	IP67

## Further technical details

<b>Operating temperature range (min, max)</b>	-25°C ... +40°C
---	-----------------

## Material properties

<b>Colour</b>	RAL 7035 grey, RAL 3000 red
---------------	-----------------------------

## Approvals / Standards

<b>Reference standard</b>	EN 60309-1 and -2
---------------------------	-------------------

## General ordering information

<b>EAN13 code</b>	8015747158183
-------------------	---------------

Part number

# PEW 63115 PQ



Catalogue drawings

(63 / 125A) PEW ... PQ

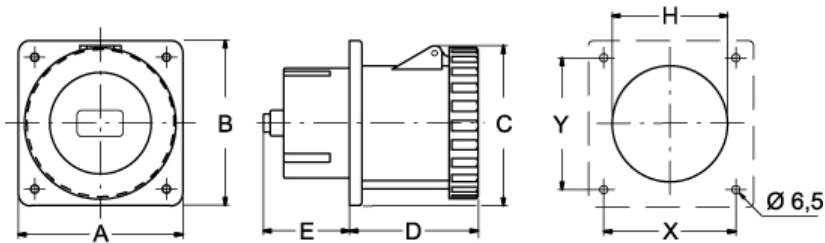

PEW ... PQ	A	B	C	D	E	H	X	Y
<b>63A</b> 2P+⊕	100	107	109	92	30	73	77	85
3P+⊕	100	107	109	92	30	73	77	85
3P+N+⊕	100	107	109	92	30	73	77	85
<b>125A</b> 2P+⊕	130	130	130	101	68	91	104	104
3P+⊕	130	130	130	101	68	91	104	104
3P+N+⊕	130	130	130	101	68	91	104	104

Notes