

Part number

PEW 63114 SI



Flush-mounting plug, PLUSO series, 3 poles + PE, 11 h (red), 63 A, 440 ÷ 460 V

Product description

Product type	Plug Flush-mounting
Series	PEW...SI, PLUSO
N. of poles	3 poles + 
Clock position	11

Technical data

Current	63 A
Voltage	440 ÷ 460 V
IP degree of protection	IP67

Further technical details

Operating temperature range (min, max)	-25°C ... +40°C
---	-----------------

Material properties

Colour	RAL 7035 grey, RAL 3000 red
---------------	-----------------------------

Approvals / Standards

Reference standard	EN 60309-1 and -2
---------------------------	-------------------

General ordering information

EAN13 code	8015747158152
-------------------	---------------

Part number

PEW 63114 SI



Catalogue drawings

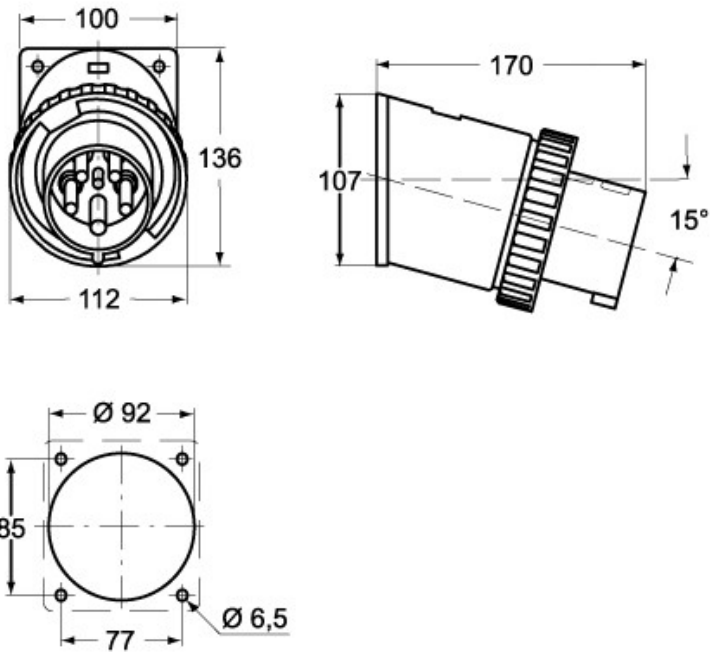

Notes